

USER MANUAL

Quicksecure™

WHEELCHAIR & OCCUPANT RESTRAINT SYSTEM

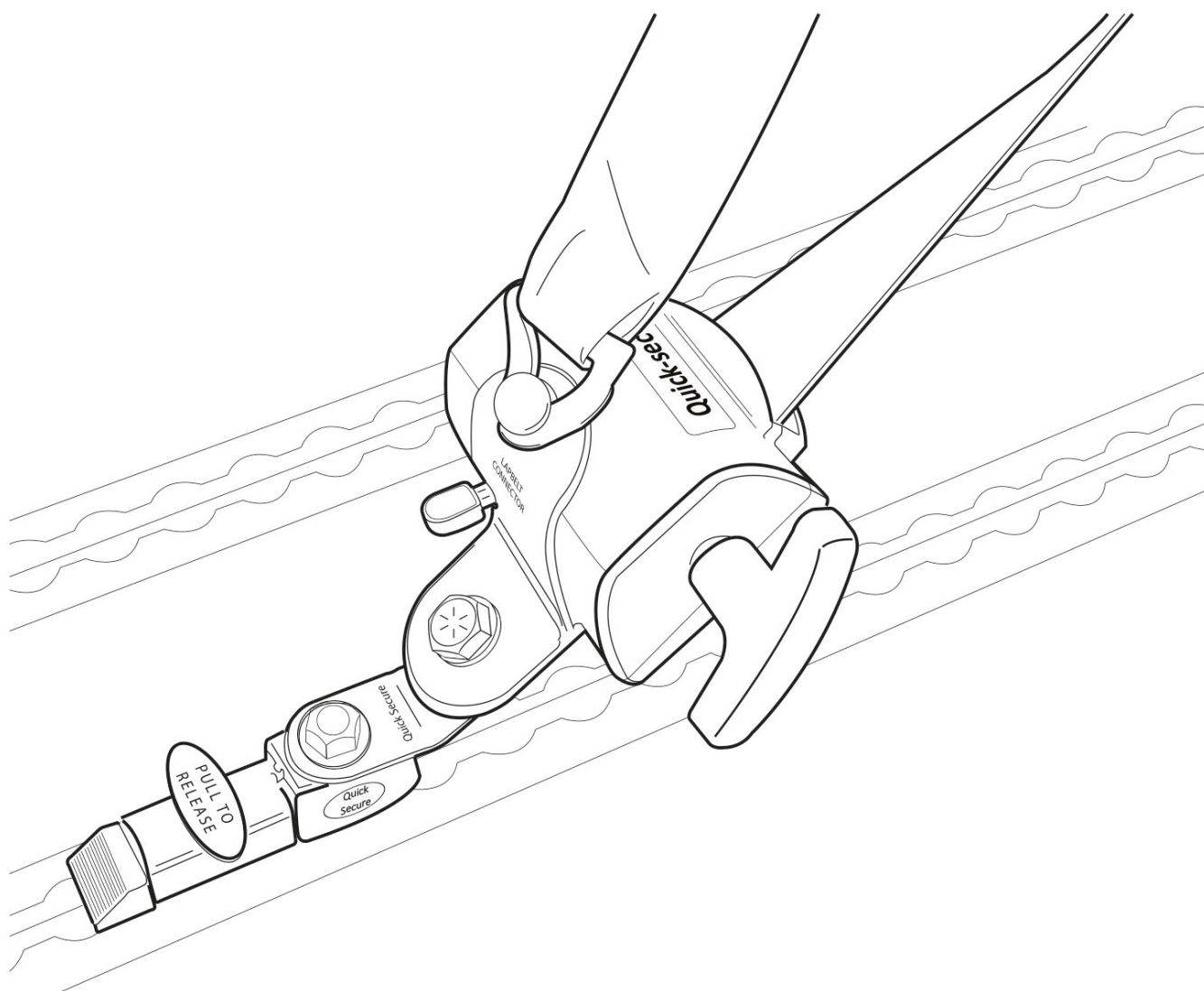

auto products

10052023

Index

General.....	2
Fitting.....	3
Maintenance.....	3
Automatic retractor for mounting in approved flooring systems.....	4
Shoulder belts for rail installation.....	5
How to position your Quicksecure floor retractor, FRONT.....	6
How to position your Quicksecure floor retractor, REAR.....	7
How to position the occupants belts.....	8
How to connect the retractor belts to the wheelchair.....	9
How to release the retractor belts.....	13
Clear zones.....	14
Part No.....	15
Rights.....	15

General:

- The Quicksecure restraint system conform to ISO 10542-1 2012
- It must only be used for forward-facing wheelchairs.
- The restraint system is only to be used for one wheelchair at a time.
- There must be no loose parts in the car that can slide into the wheelchair while driving.
- Be aware that the installed restraint system does not interfere with the vehicle airbags.
- Components inside the clear zone must have padding conforming to FMVSS 201/ECE R 21.
- The burning rate of additional vehicle interior padding must not exceed 100 mm/min when tested in accordance to ISO 3795.
- The restraint system must not be mixed with parts and components from different brands/dealers.
- Wheelchairs to be used as a seat in a vehicle must have at least 2 front and 2 rear designated securement points for the WTORS system. according to ISO 7176-19. Wheelchairs not having such securement points should not be used.

Fitting:

The wheelchair tiedown (4 retractors with hooks) must be placed within the zones - see illustrations on pages 6-8.

If you are having tiedowns without handle for manual tension, these must be mounted in the front. Always use tiedowns with handle for manual tension at the rear to have the wheelchair properly fixed, not rocking.

The pelvic belt should be worn low across the front of the pelvis so that it rests on the bony structure of the body, with any joints between the pelvic and shoulder supports located near the passenger's hip. The angle of the pelvic belt should be within the preferred zone, see illustrations on pages 6-8.

Belt should be placed to follow the body for optimal distribution of forces (in case of crash) on the body. See illustration "Belt" on page 8 showing parts such as wheels or armrests, that can reduce the function of the WTORS. Adjust the belts as firmly as possible consistent with user comfort. Fit the upper-torso belts accross the shoulder and never on the passangers neck. The belts must twist as little as possible.

The extent of head and chest excursions also depend on the location of the upper torso belt anchor points and may enhance as anchor point distance above and behind the occupant's shoulder increases.

Maintenance:

- Prevent any contact with polishes, oils and chemicals, particularly battery acid (H₂SO₄)
- Cleaning: Use cleaning solutions e.g. soap flakes without chemicals. Remember to extend the belts fully and let them dry completely to prevent water from entering and damaging retractors.
- Protect webbing from contacting sharp corners and edges.
- Parts should be replaced if frayed, contaminated, worn or broken.
- The entire system should be replaced if it has been implicated in an accident.
- When not in use, always store belts so they are not exposed to mud, sand or water. In particular, if it is the long fixed belt that is used, it should be clicked together so that it does not come into contact with the floor or anything else that can make it dirty.

**AUTOMATIC Wheelchair
belt retractor**

Quicksecure™
WHEELCHAIR & OCCUPANT RESTRAINT SYSTEM

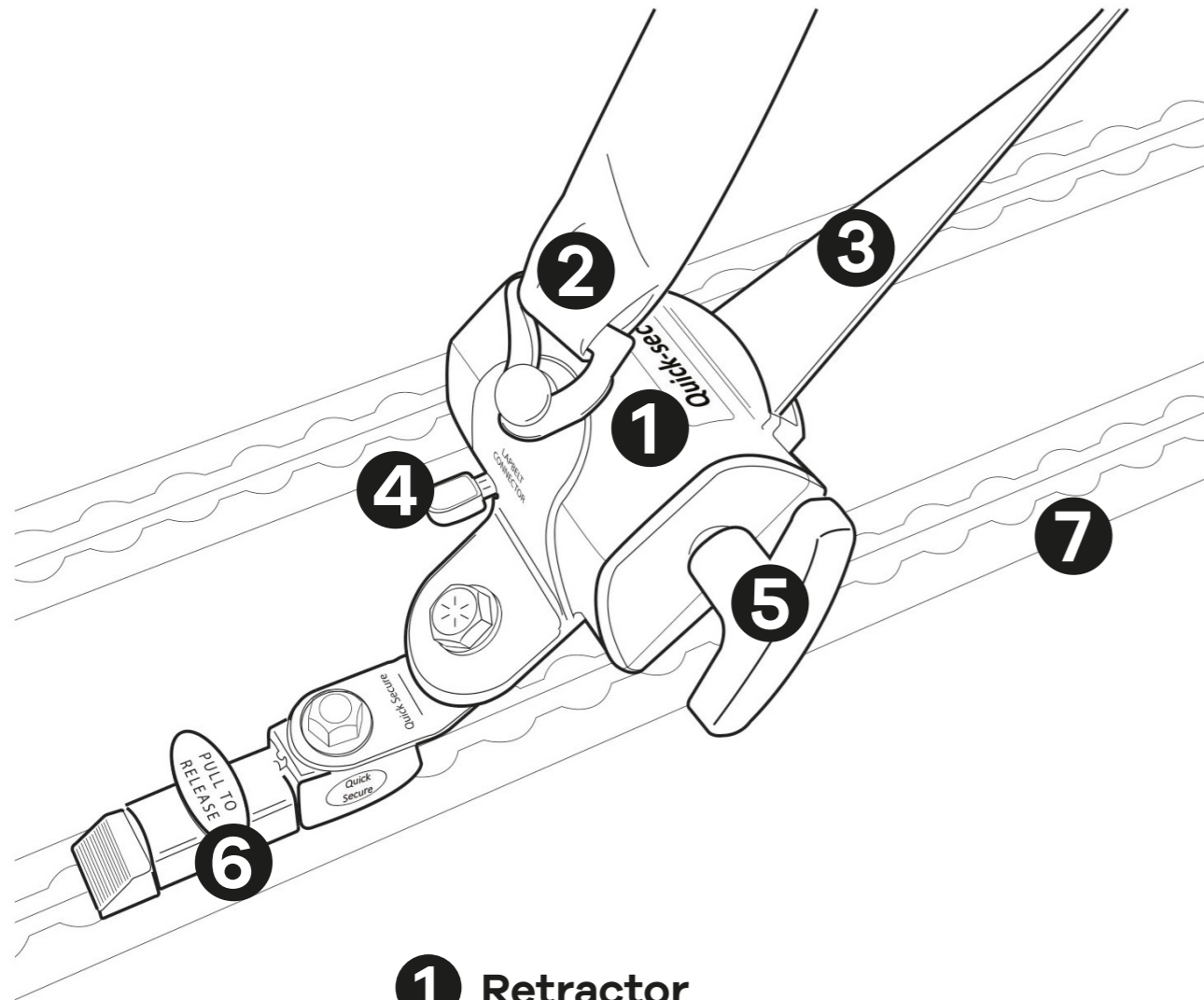

- 1** Retractor
- 2** Lap belt
- 3** Tiedown belt with fastening hook
- 4** Belt release button
- 5** Belt tightening handles
- 6** Retractor release handle
- 7** Approved aluminium floor

**AUTOMATIC retractor
shoulder belt**

Quicksecure™
WHEELCHAIR & OCCUPANT RESTRAINT SYSTEM

- 1** Release handle
- 2** Shoulder belt
- 3** Approved aluminium rail

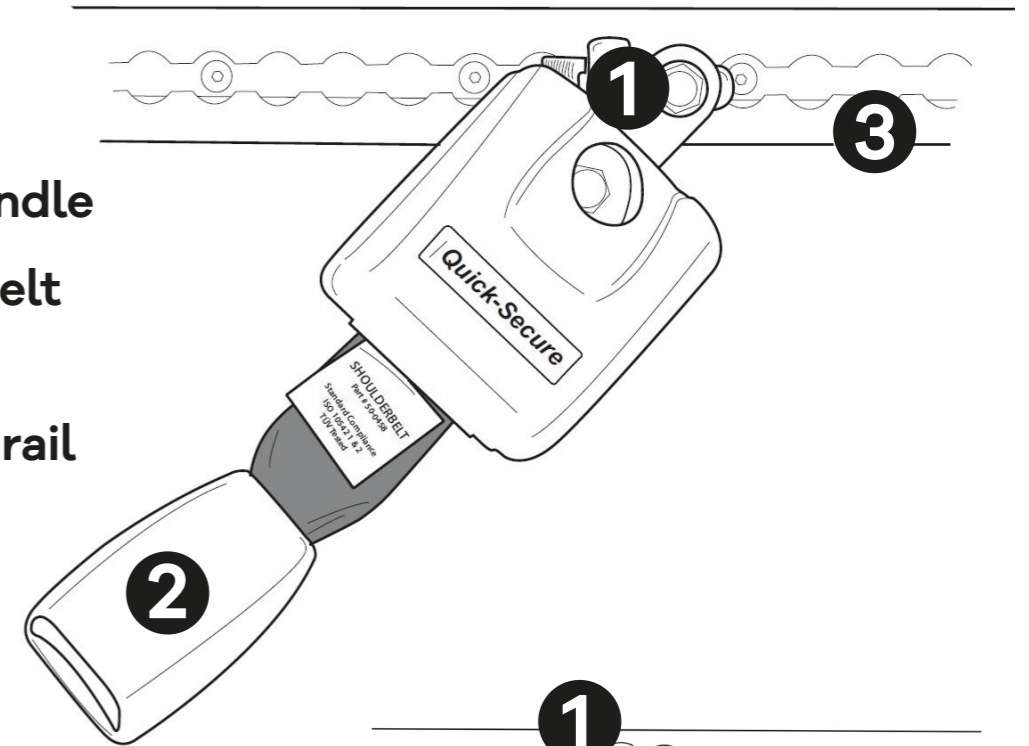

**FIXED
Shoulder Belt**

- 1** Release handle
- 2** Shoulder belt
- 3** Approved aluminium rail

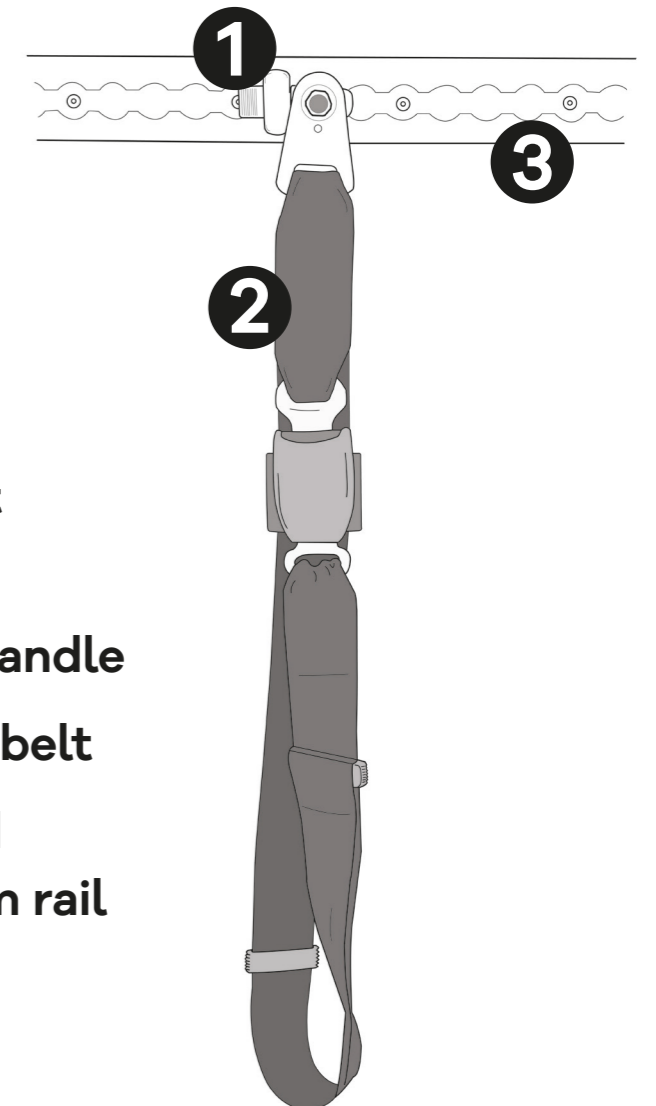

How to position your
Quicksecure floor retractor,
FRONT

Quicksecure™
WHEELCHAIR & OCCUPANT RESTRAINT SYSTEM

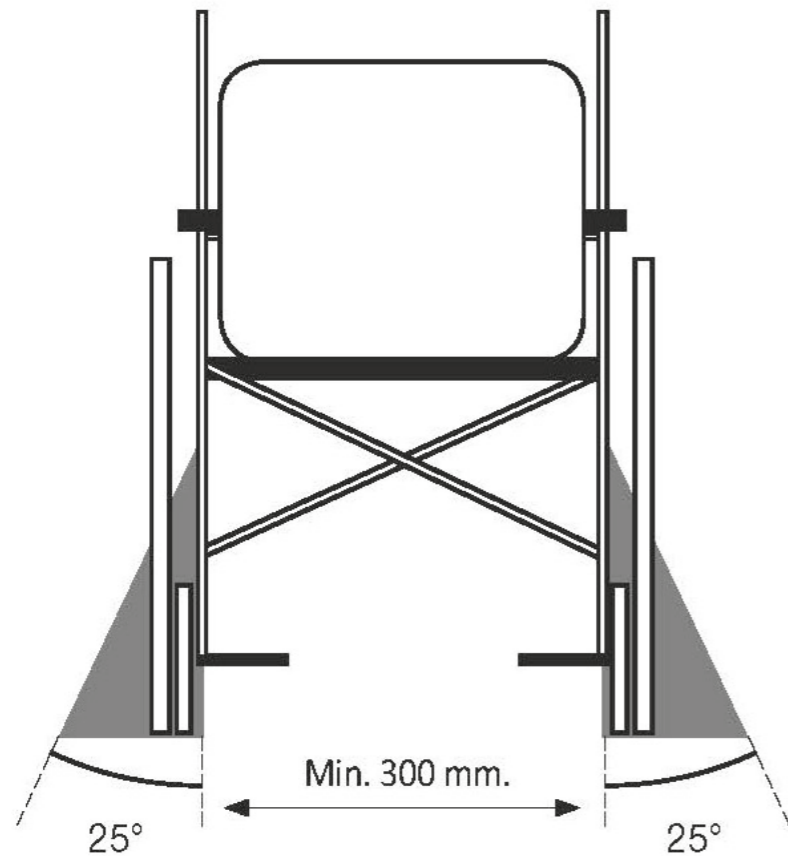
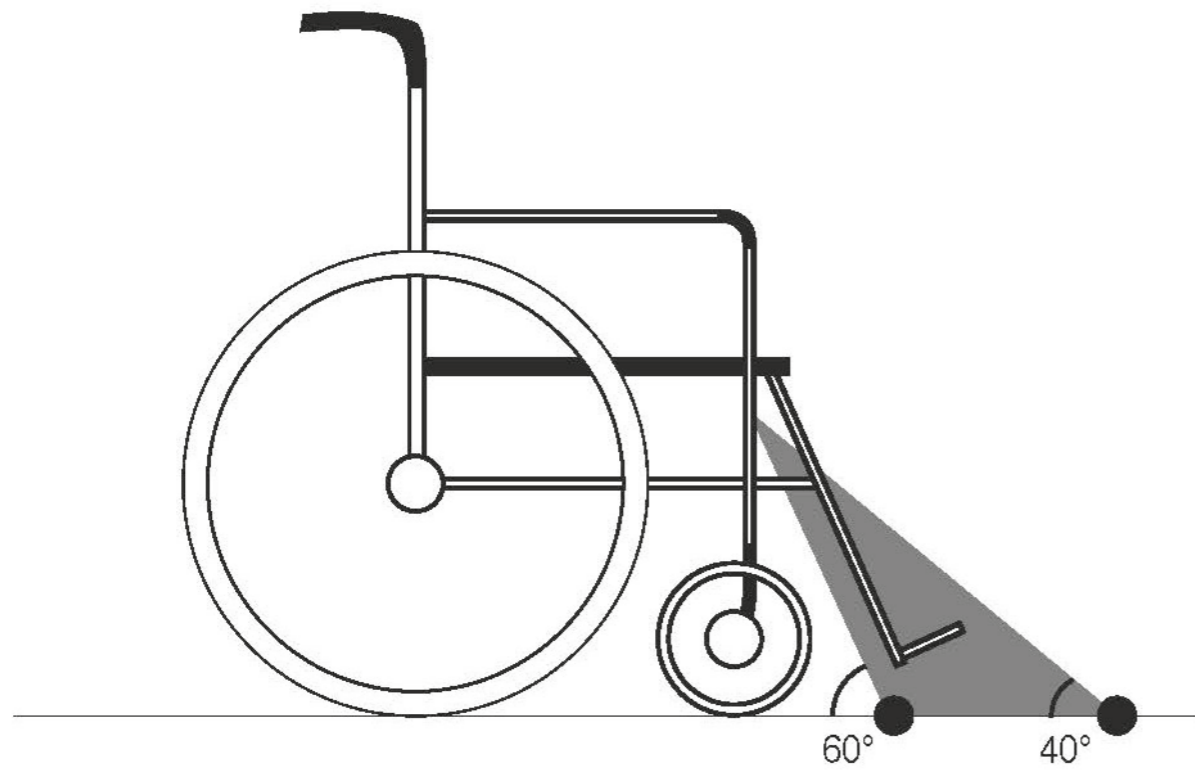

How to position your
Quicksecure floor retractor,
REAR

Quicksecure™
WHEELCHAIR & OCCUPANT RESTRAINT SYSTEM

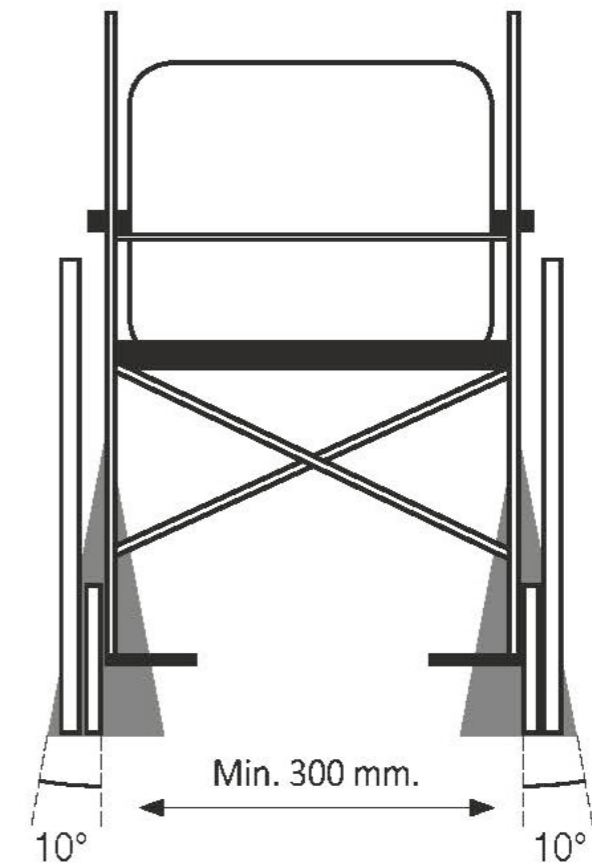
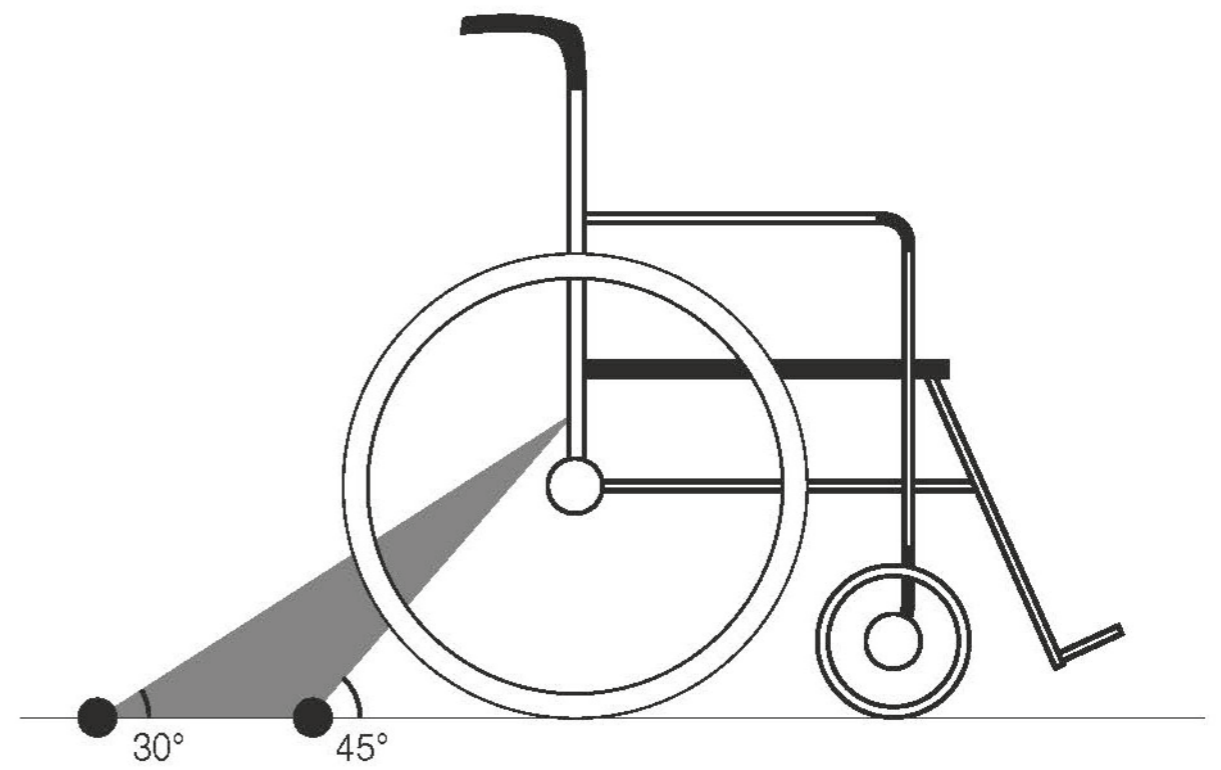

How to position the occupant belts

Passengers must be restrained by a person who have received training in using the restraint system.
All belts must be tensioned around the passenger, not the wheelchair.

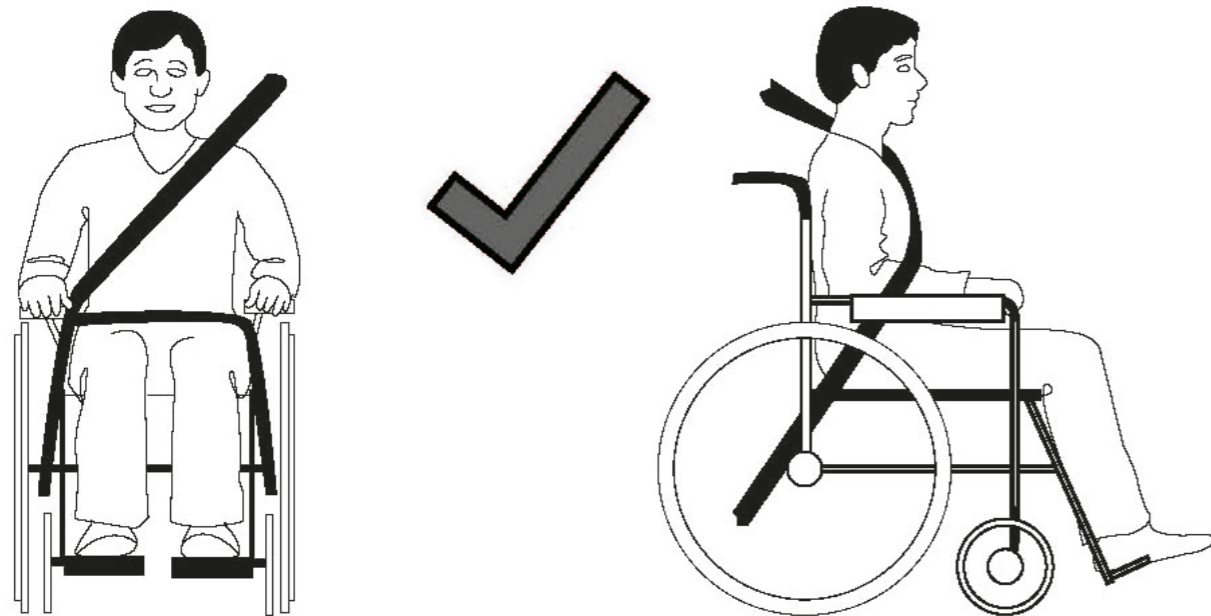
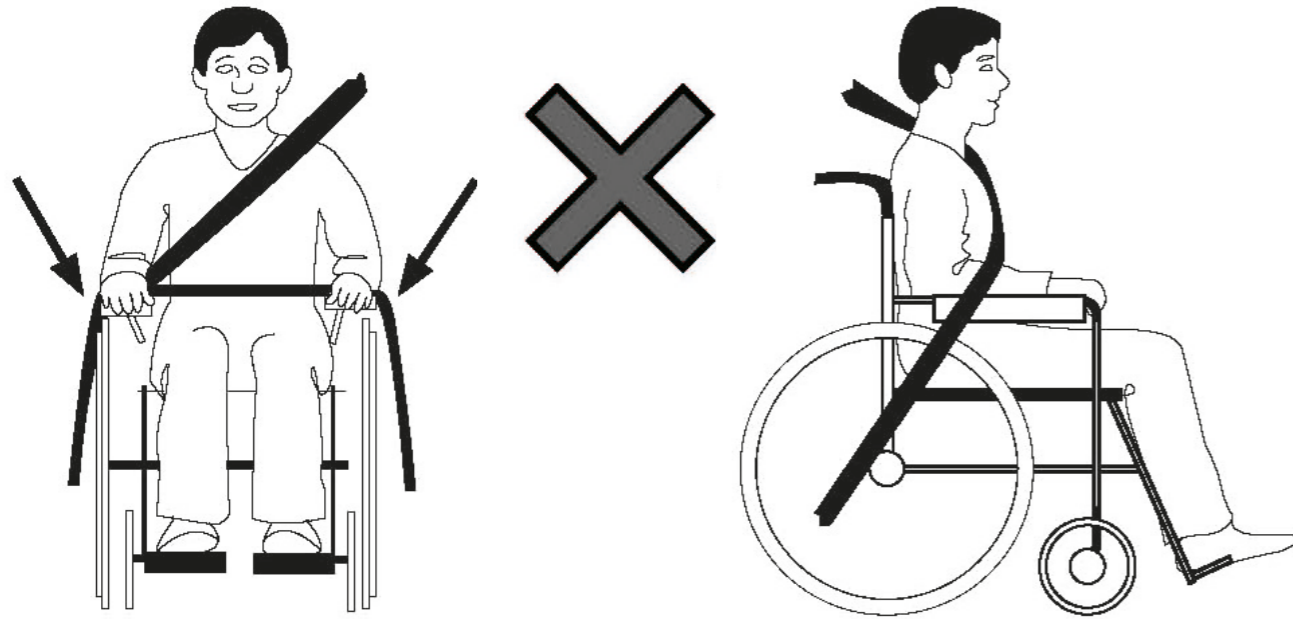

How to connect the retractor belts to the wheelchair

1 Insert the four retractors into the tracks.

Lift the red handle labeled "PULL TO RELEASE"
Place the retractor into the track.
Let go of the handle.

Slide the retractor until it fastens with a "click".

See correct positions on pages 6 and 7.

NOTE: If you have retractors without tensioning handles, these must always be positioned in front of the wheelchair.

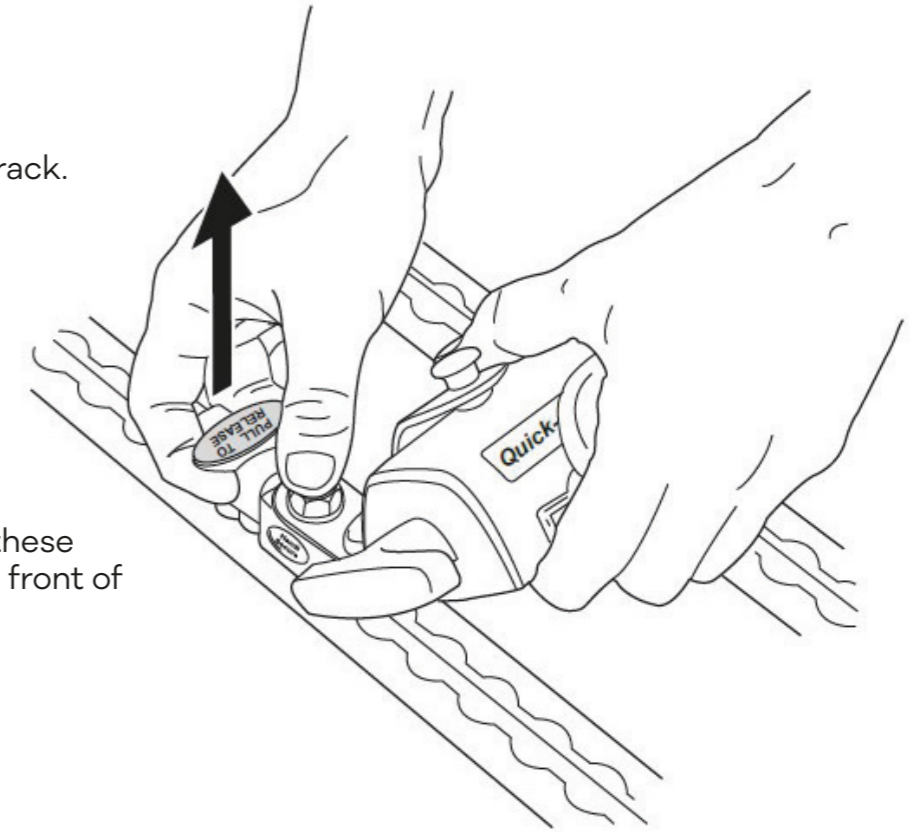

2 Press the red release lever.
Pull out the belt.

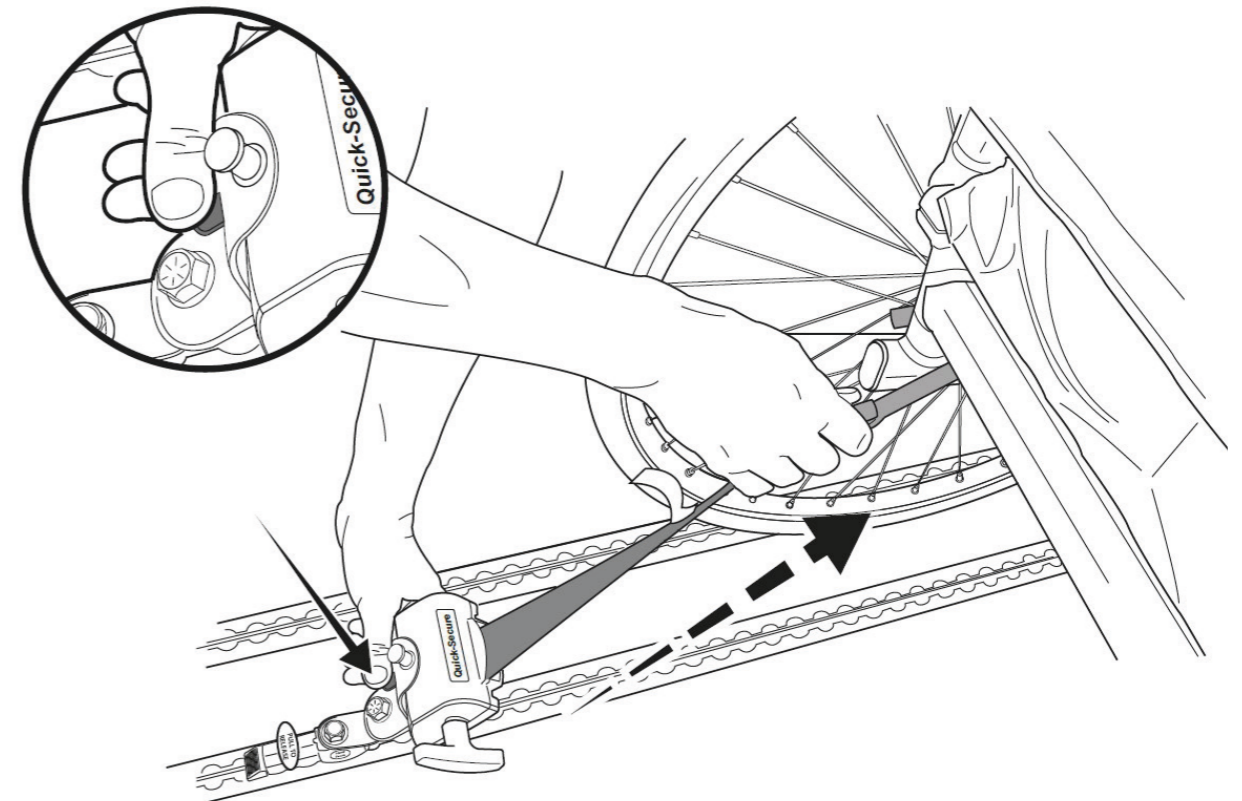

Quicksecure™

WHEELCHAIR & OCCUPANT RESTRAINT SYSTEM

3 Connect the hooks to the frame of the wheelchair.

If the wheelchair has labels showing securement points (anchorage points), use these.

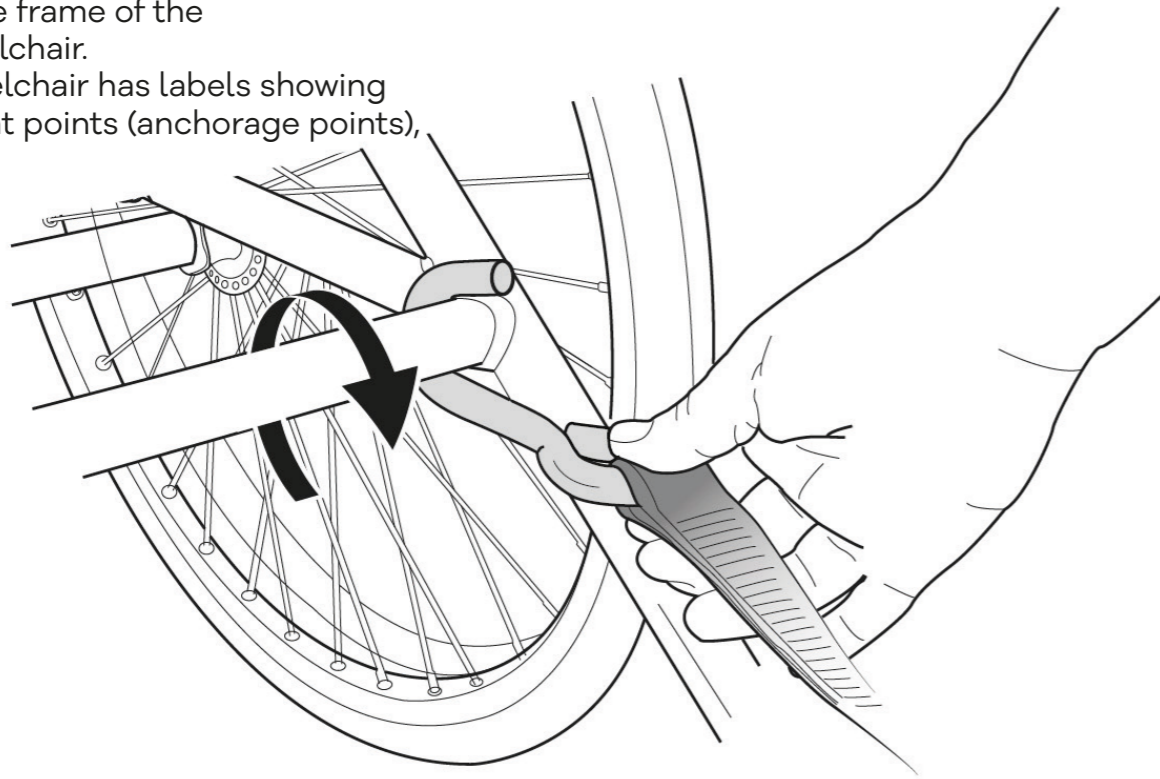

4 Fasten the tiedown belts using the black handles on rear tiedown.

Make sure, the wheelchair can not move.

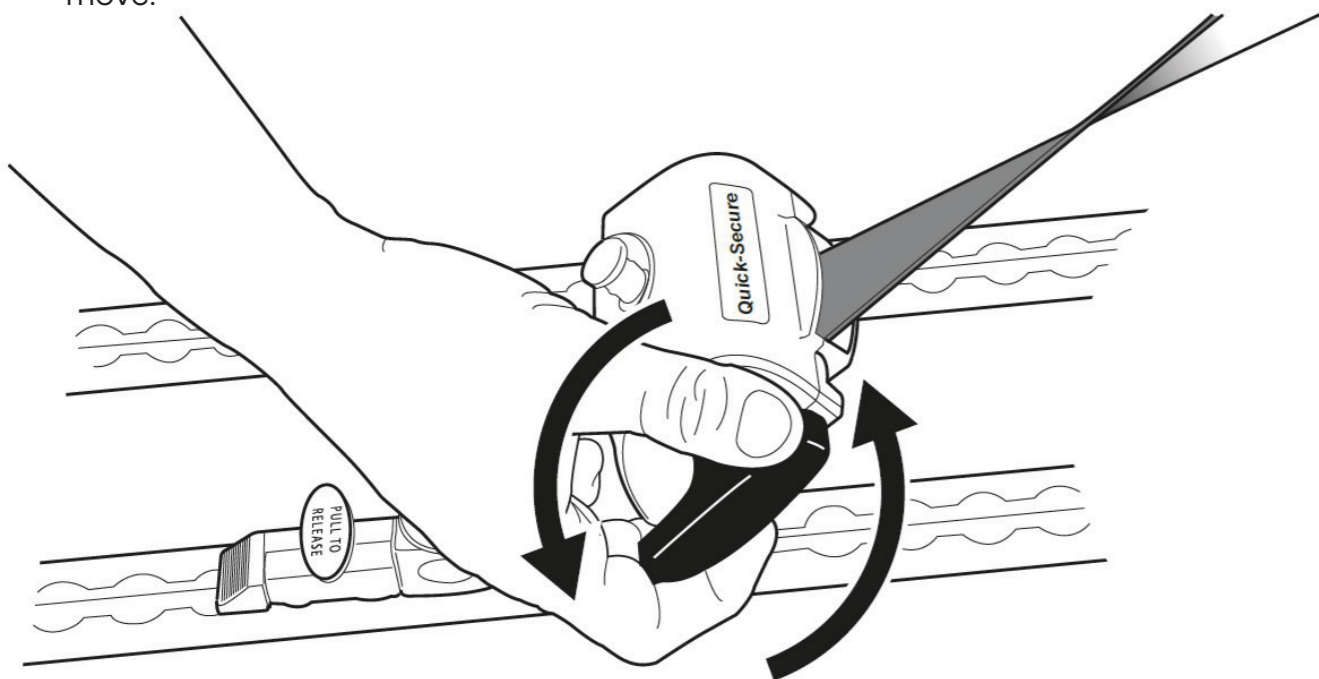

Quicksecure™

WHEELCHAIR & OCCUPANT RESTRAINT SYSTEM

5 Connect the lap belt to the pin on each of the two rear retractors.

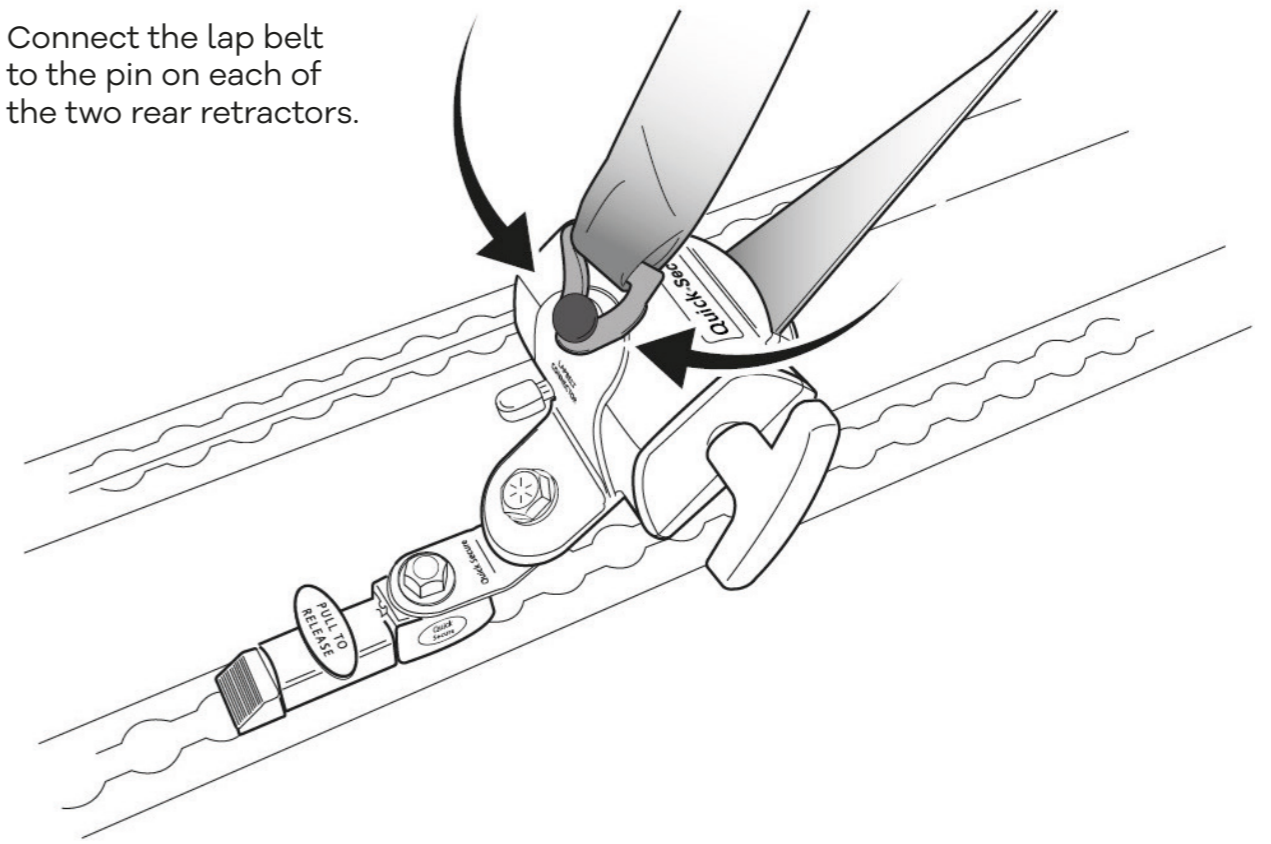

6 Lock the lap belt buckle in front of the passenger as low as possible and close to the hip.

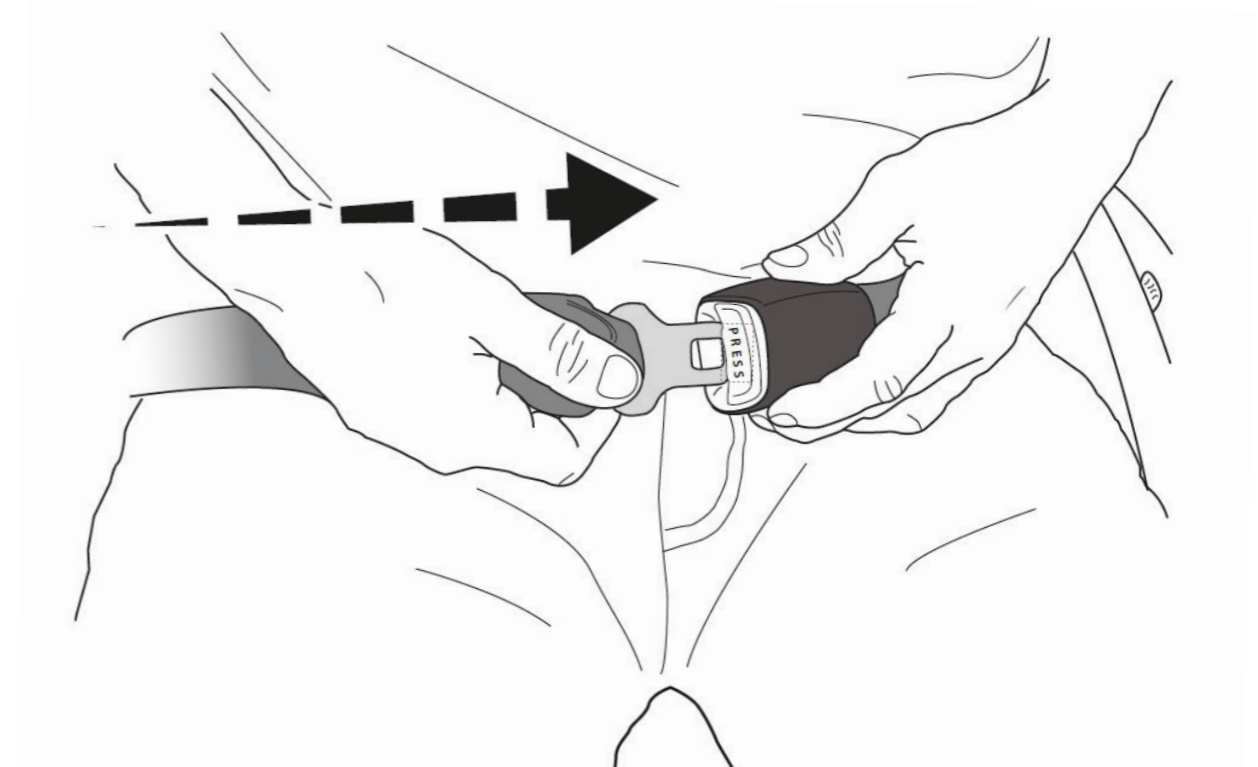

Quicksecure™

WHEELCHAIR & OCCUPANT RESTRAINT SYSTEM

7 Tighten the lap belt to the left.

Adjust the belts firmly, consistent with user comfort.

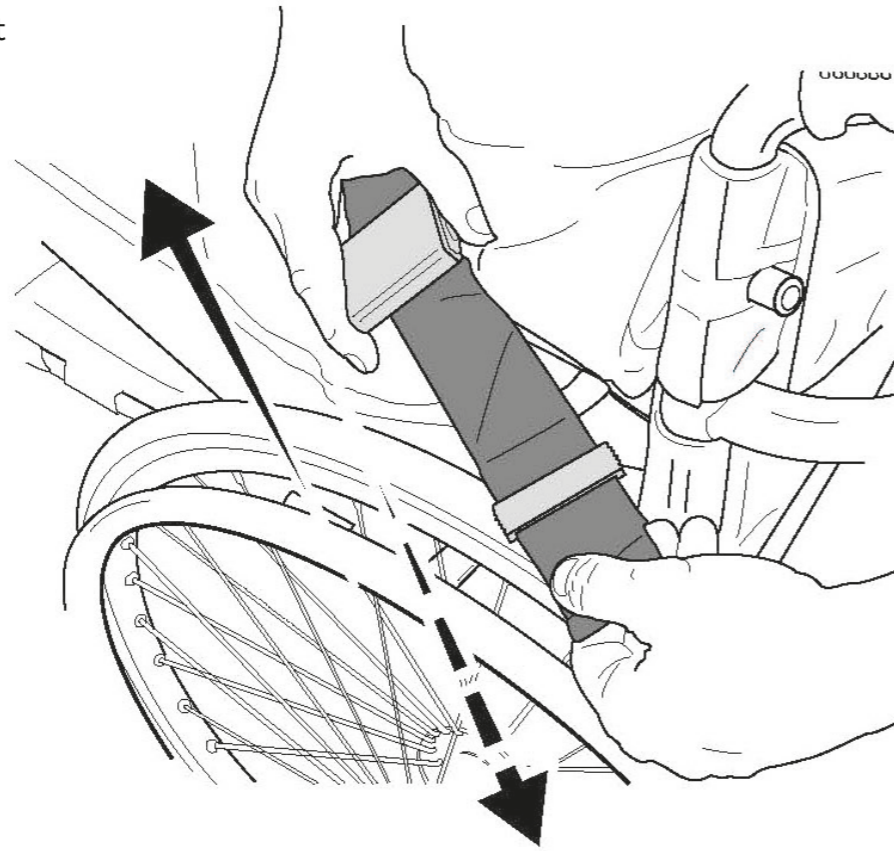

8 Grab the shoulder belt buckle from the upper anchorage point and pull the seat belt down across the middle of the passenger's shoulder.

Automatic shoulder belt retractor illustrated.

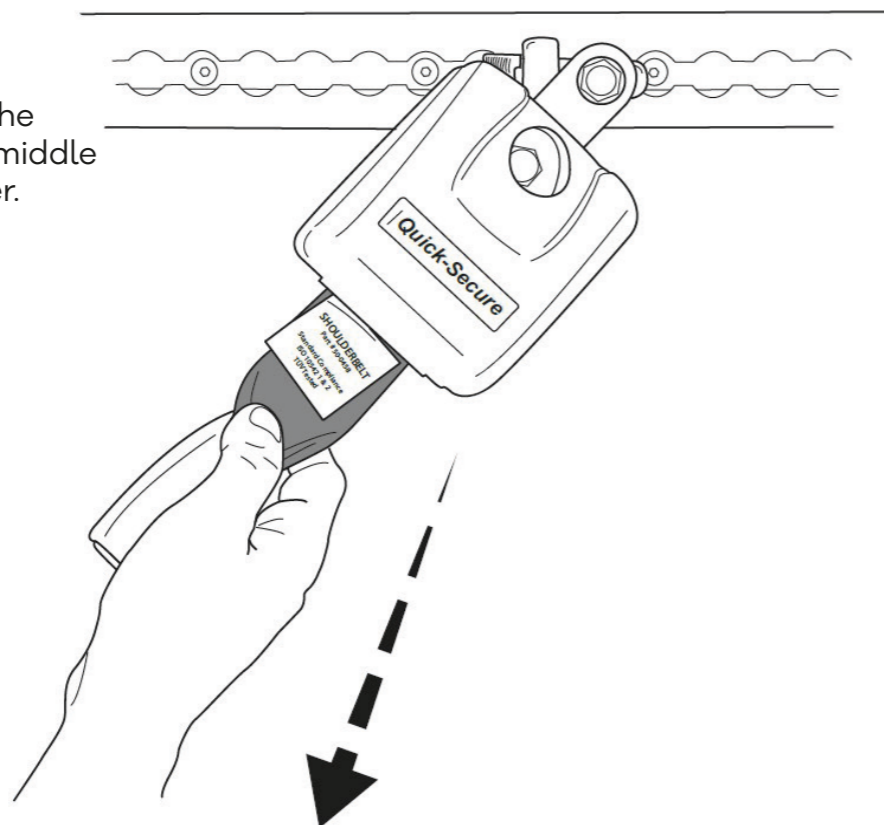

Quicksecure™

WHEELCHAIR & OCCUPANT RESTRAINT SYSTEM

9 Connect the shoulder belt to the lap belt.

The automatic shoulder belt should tighten automatically once you let go. If not: pull lightly and let go again until it tightens.

The static shoulder belt must be tightened manually.

Tighten the static shoulder belt strap like you do the lap belt.

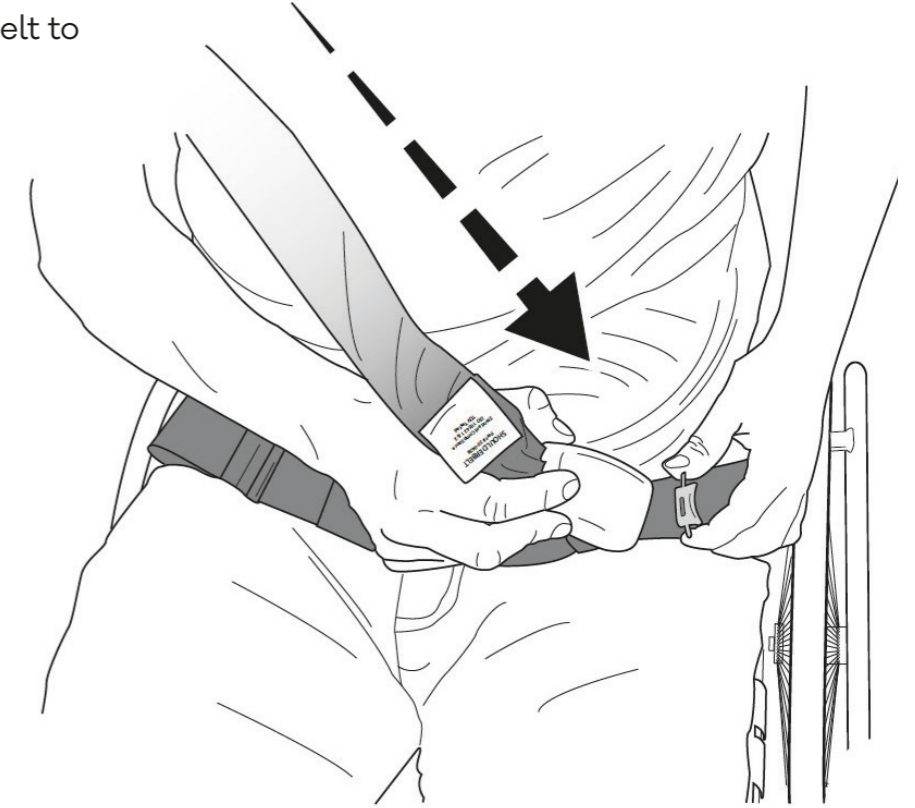

How to release the retractor belts

To release the retractor belts from the wheelchair, press the red release lever.

If needed, turn the tightening handle a little to loosen the tension on the red release handle.

NB! Press the lever only by hand – do not step on it.

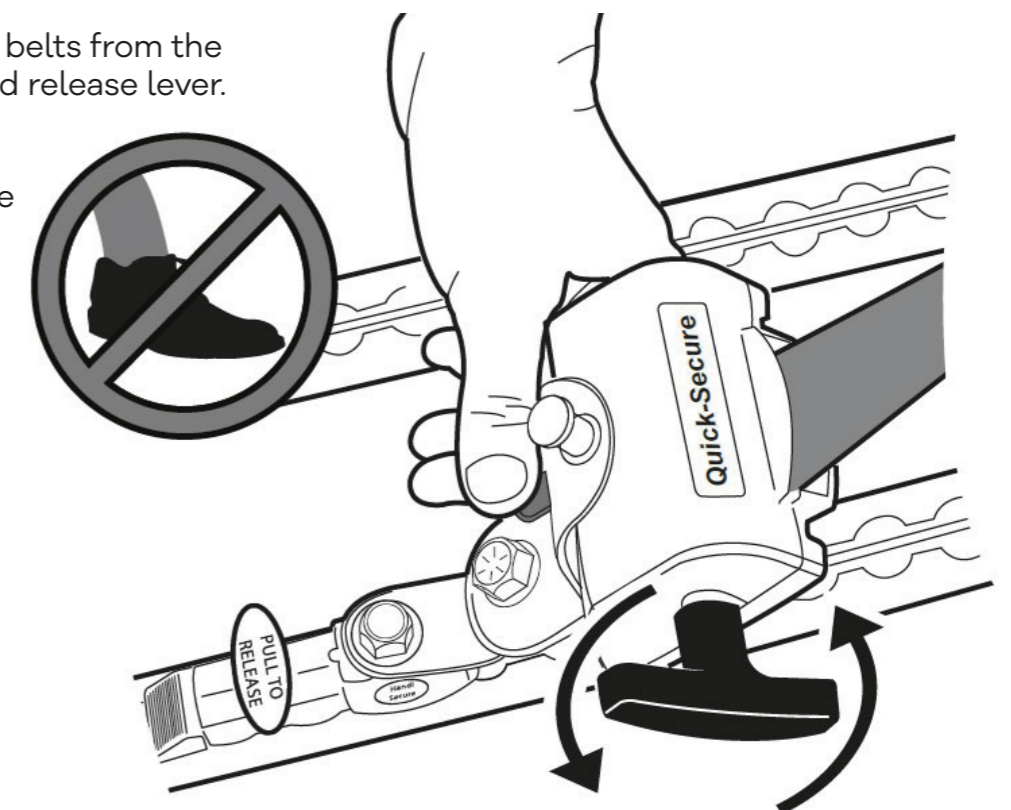

Clear Zones

There must be a clear zone around the passenger according to the illustrations below.

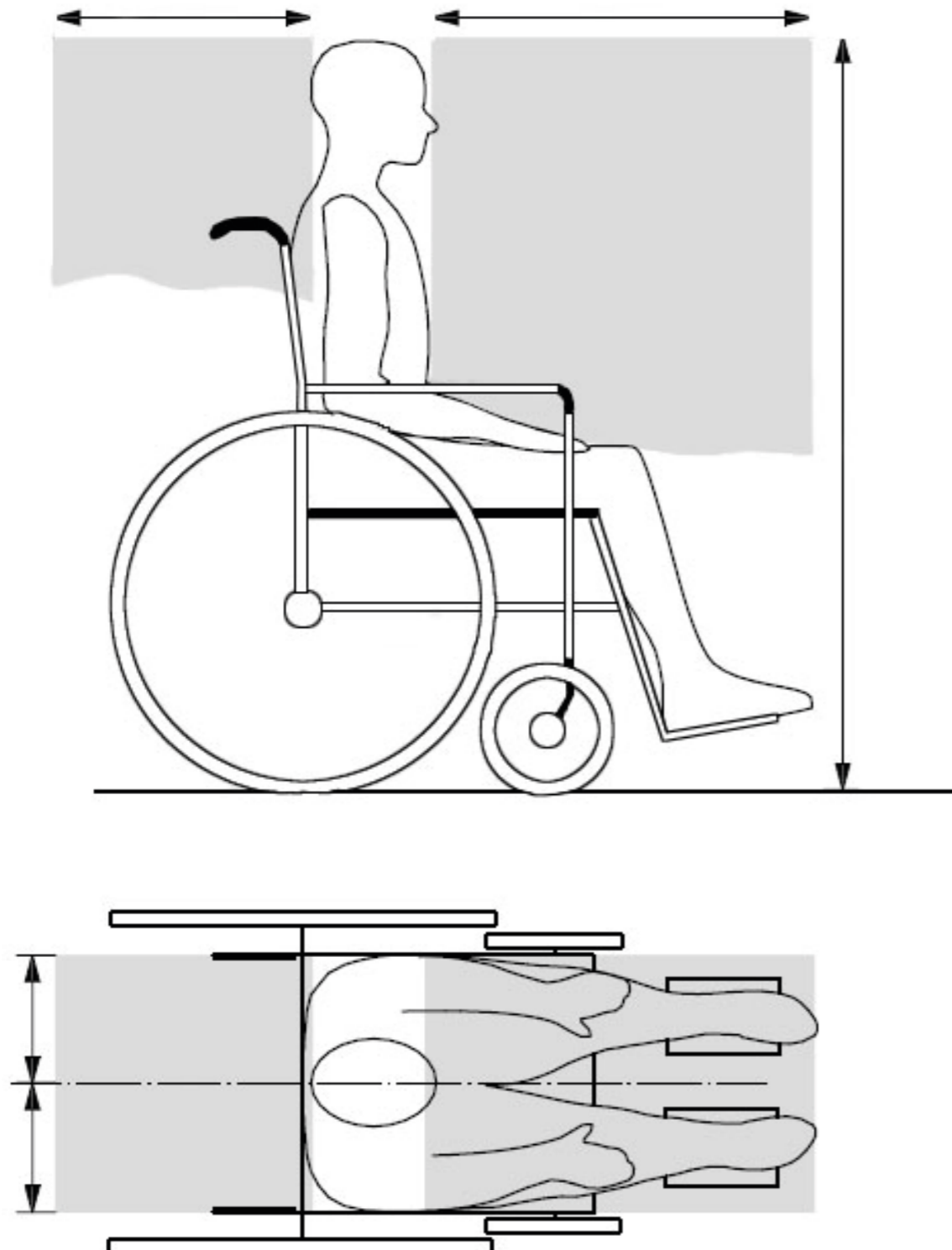

Part No.

Set with automatic shoulder belt (HS01-A)

2000SA-TP1 XL : Wheelchair tie down
50-0363 : Lap Belt
50-0458 : Shoulder Belt

Set with static shoulder belt (HS01-S)

2000SA-TP1 XL : Wheelchair tie down
50-0363 : Lap Belt
60-042 : Shoulder Belt

Alternative:

REAR - Wheelchair tie down:

2000SA-TP1-XL
2000SA-TP2-XL
2000SA-TP1-XL/O/C
2000SA-TP2-XL/O/C

FRONT - Wheelchair tie down:

2000SA-TPO-XL
2000SA-TPO-XL/B a
2000SA-TP1-XL
2000SA-TP2-XL
2000SA-TP1-XL/O/C
2000SA-TP2-XL/O/C

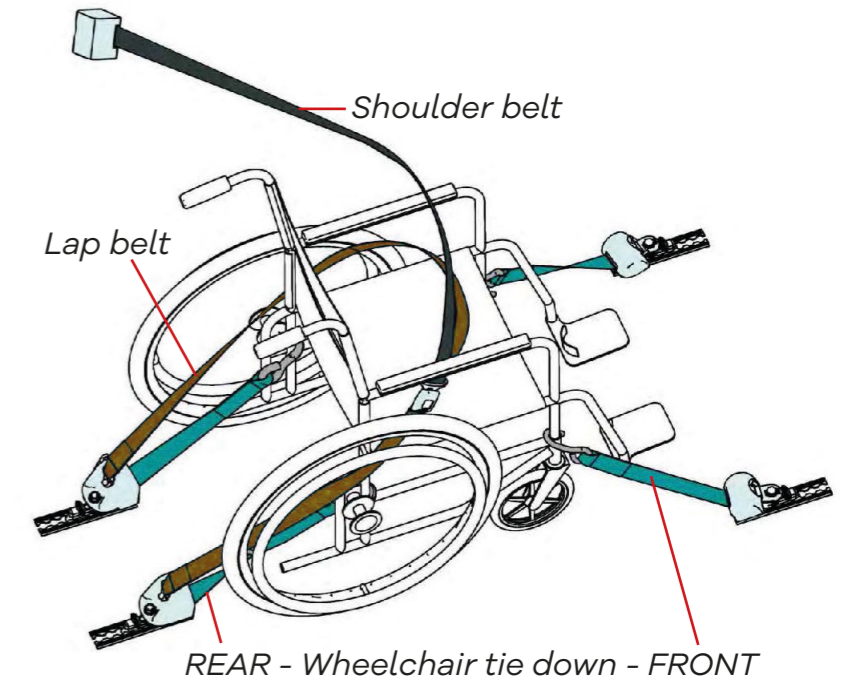

© 2023 Autoproducts - All rights reserved

The information provided herein may not be reproduced and/or published in any form, by print, photoprint, microfilm or any other means whatsoever (electronically or mechanically) without the prior written authorization of Autoproducts.

The information provided is based on general data concerning the construction known at the time of the publication of this manual.

Autoproducts executes a policy of continuous improvement and reserves the right to changes and modifications.

The information provided is valid for the product in its standard version. Autoproducts can therefore not be held liable for any damage resulting from specifications of the product deviating from the standard configuration. Illustrations contained in the manual may deviate from the configuration of your product.

The information made available has been prepared with all possible diligence, but Autoproducts cannot be held liable for any errors contained in the information or the consequences thereof. Autoproducts accepts no liability for loss resulting from work executed by third parties. Names, trade names, trademarks etc. used by Autoproducts may not, as per the legislation concerning the protection of trade names, be considered as being available.

auto products

Baggeskærvej 48
DK-7400 Herning

T +45 88 18 17 03
sales@autoproducs.dk
www.autoproducs.eu