

MOUNTING INSTRUCTIONS

EN

handiRDO™

REAR DOOR OPENER

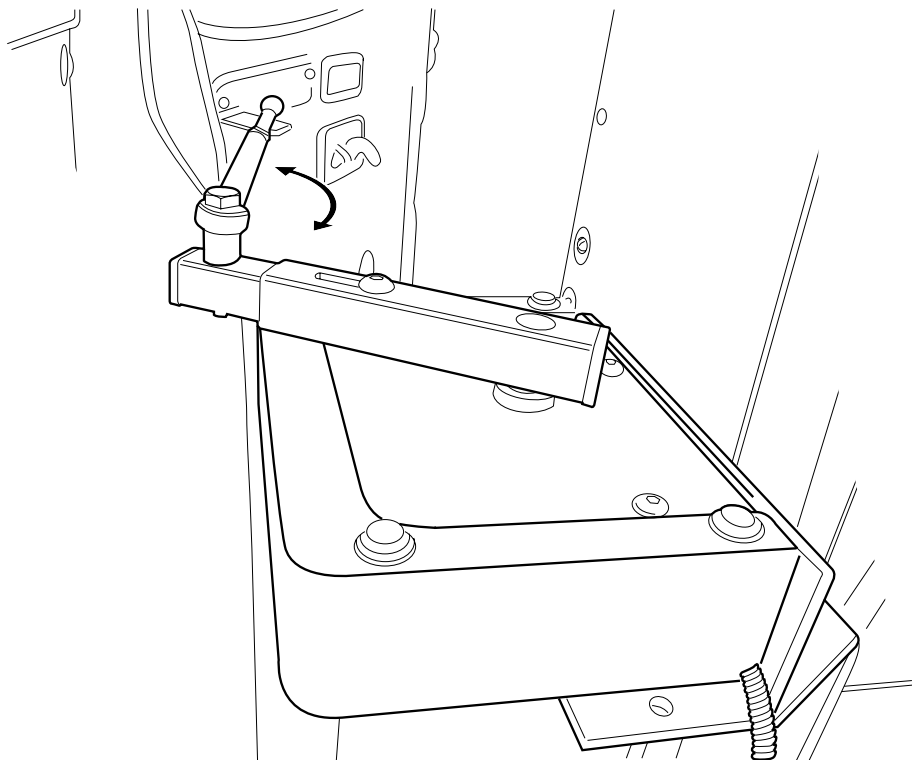

FOR MOUNTING IN VEHICLES:



NISSAN
INTERSTAR



OPEL
MOVANO



RENAULT
MASTER



VW
T5



MERCEDES
SPRINTER / VIANO



autoproducts

Version 1,0 2022

ENGLISH

© 2012 Autoproducts

All rights reserved.



The information provided herein may not be reproduced and/or published in any form, by print, photoprint, microfilm or any other means whatsoever (electronically or mechanically) without the prior written authorization of **Autoproducts**.

The information provided is based on general data concerning the construction known at the time of the publication of this manual. **Autoproducts** executes a policy of continuous improvement and reserves the right to changes and modifications.

The information provided is valid for the product in its standard version. Autoproducts can therefore not be held liable for any damage resulting from specifications of the product deviating from the standard configuration. Illustrations contained in the manual may deviate from the configuration of your product.

The information made available has been prepared with all possible diligence, but **Autoproducts** cannot be held liable for any errors contained in the information or the consequences thereof. **Autoproducts** accepts no liability for loss resulting from work executed by third parties. Names, trade names, trademarks etc. used by **Autoproducts** may not, as per the legislation concerning the protection of trade names, be considered as being available.

HandiRDO™ / Universal lift bracket

Package overview.....4

Configurations.....5

Universal lift bracket.....6

Mounting of lift bracket.....7

Mounting of door opener onto universal lift bracket.....8

Connection.....10

Adjustment.....14

Mounting of door bracket

MMI - Bracket kit 61526 - Renault Master | Opel Movano | Nissan Interstar.....16

VW T5 - Bracket kit 6159424

Mercedes Sprinter - Bracket kit 6159630

Mercedes Vito/Viano - Bracket kit 6159930

User guide.....38

User guide for wireless control.....40

Certification.....42

Warranty.....43

Package overview

handiRDO™
REAR DOOR OPENER

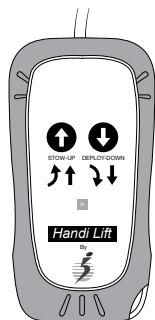
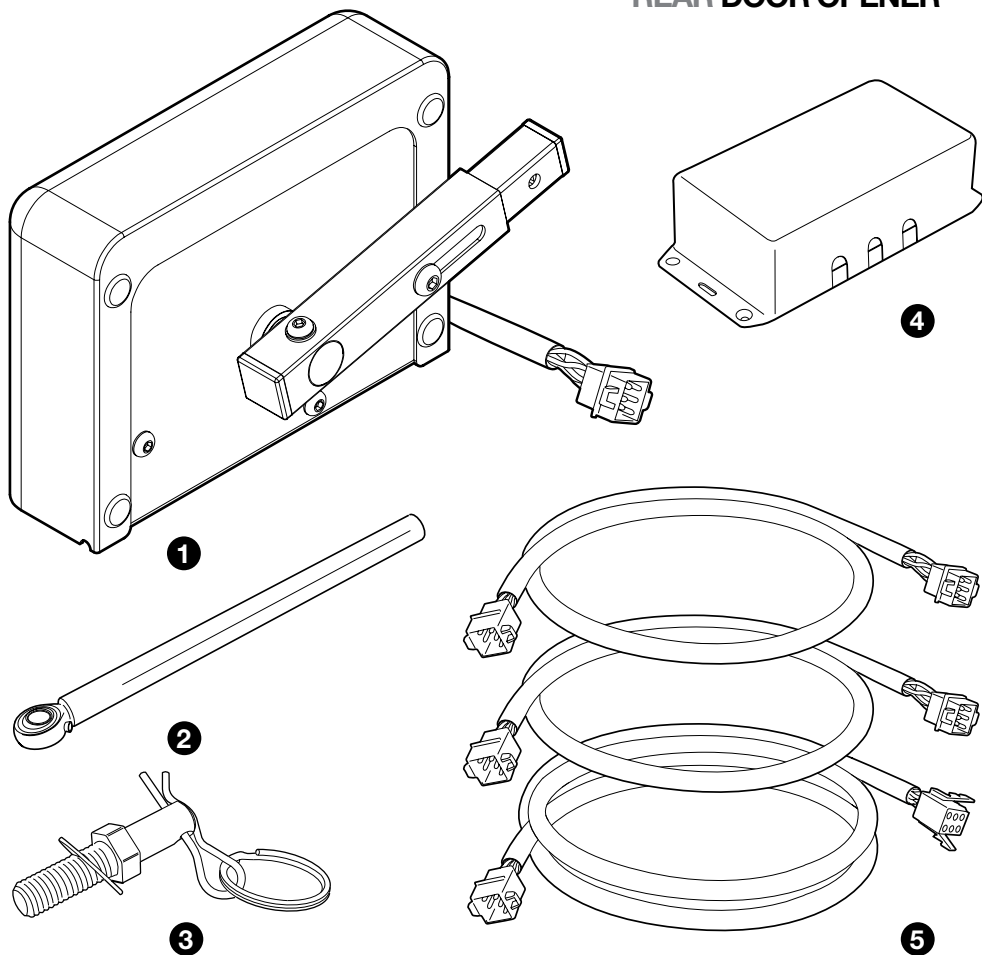

6

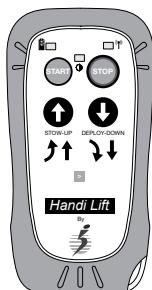

6a

- 1** 2x HandiRDO™
- 2** 2x Mounting rods
- 3** 2x Emergency release pins
- 4** 1x Control box
- 5** 3x Cables
- 6** 1x Remote control (optional)
- 6a** 1x Wireless control (optional)

Configurations

handiRDO™ REAR DOOR OPENER

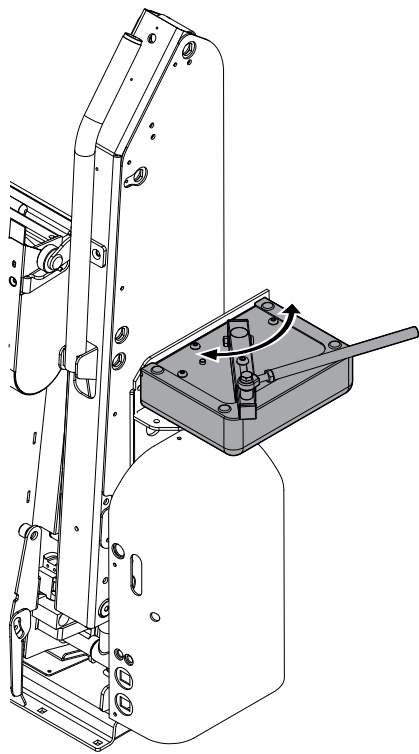

(Not possible on bracket from 8-2022)

Horizontal

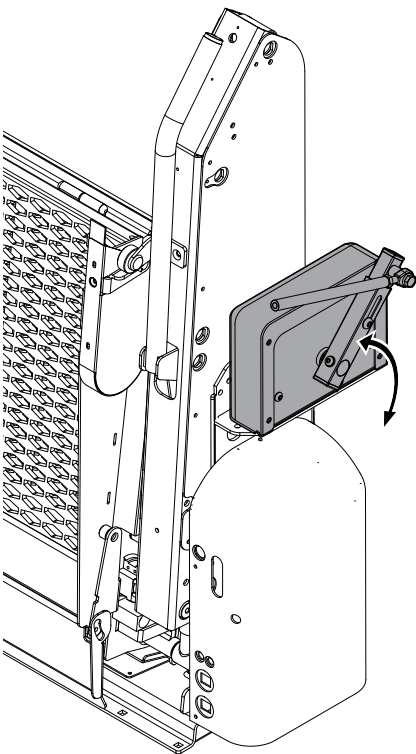

Vertical

The door opener can be mounted in two ways; vertical or horizontal, either way it has full functionality.

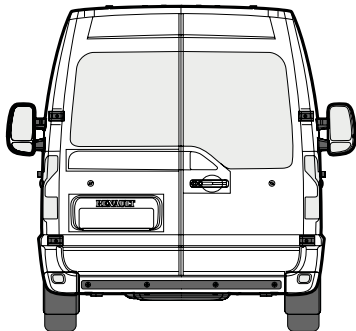

Left

Right

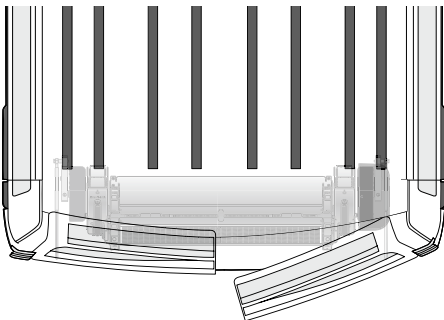

Left

Right

Universal lift bracket

handiRDO™
REAR DOOR OPENER

Bracket has new design from 8-2022

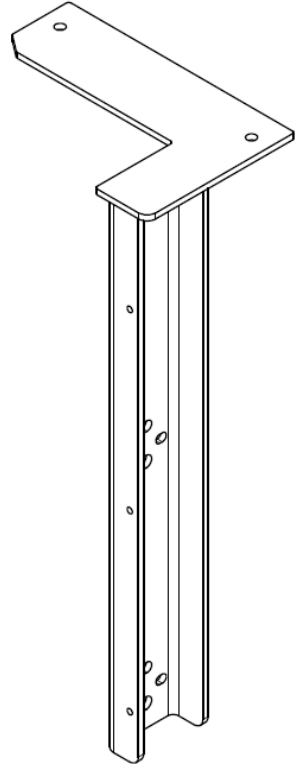
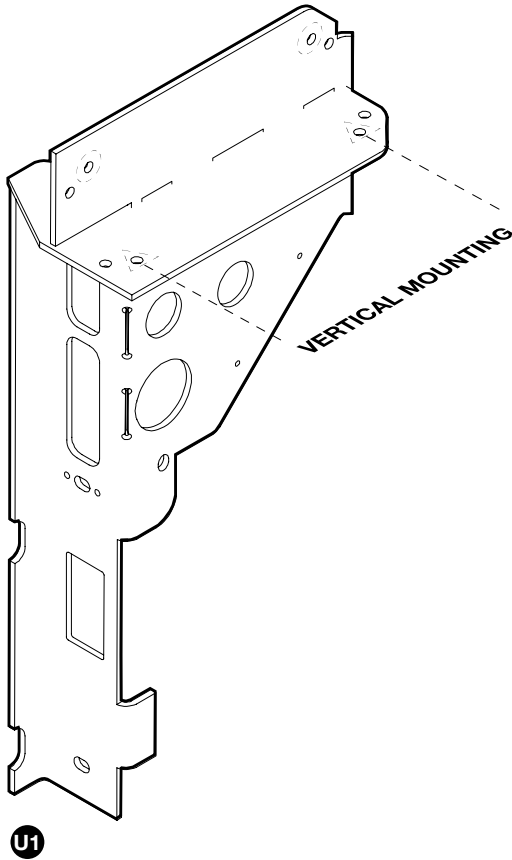

U3



U4



U5



U6



U7



U8

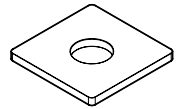

U9

U1 1x Universal lift bracket (Right)

U2 1x Universal lift bracket (Left)

U3 4x M8x16 mm Bolt

U4 4x M8 Nut

U5 4x M8x30 mm Bolt

U6 4x M8 Washser

U7 4x M8 Washser

U8 4x M8 Spring washser (optional)

U9 4x Spacer (optional)

Mounting of lift bracket

handiRDO™

REAR DOOR OPENER

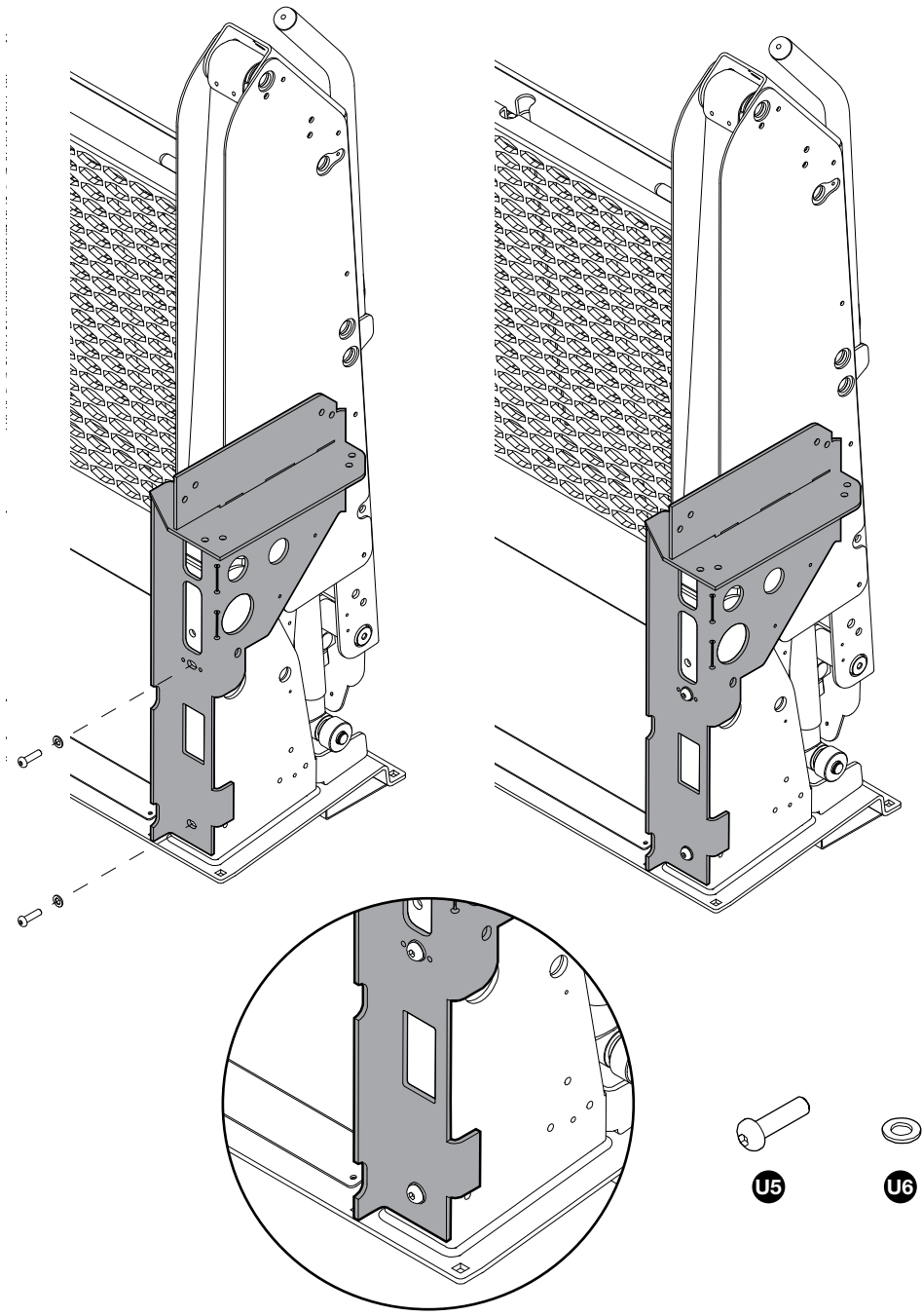

Mounting of door opener onto universal bracket

handiRDO™
REAR DOOR OPENER

Take off the cover of the HandiRDO™.

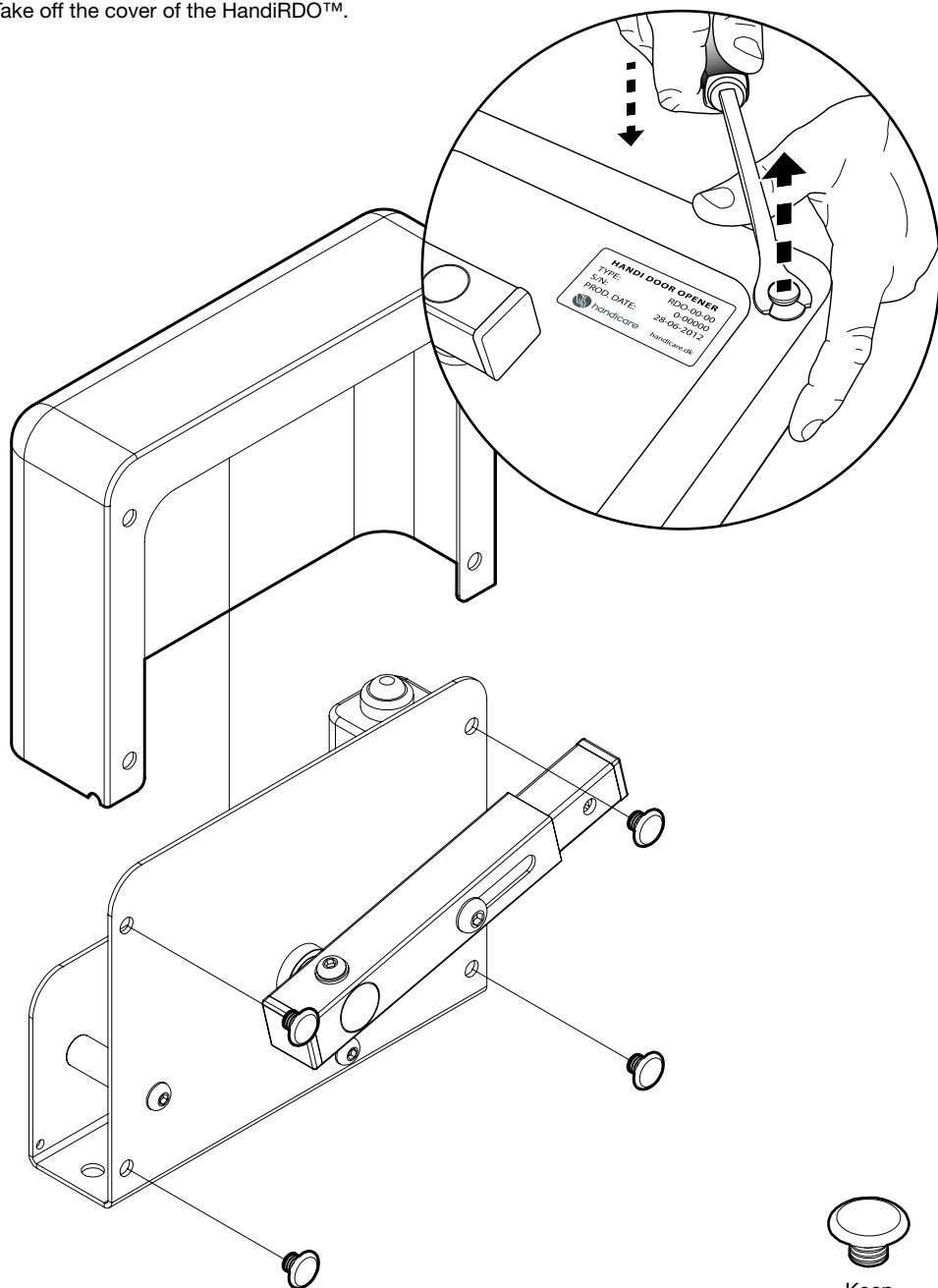

Mounting of door opener onto universal bracket

handiRDO™
REAR DOOR OPENER

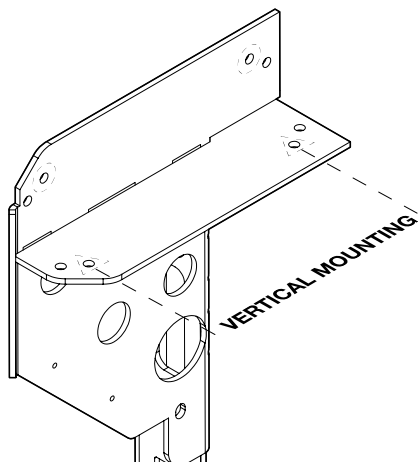
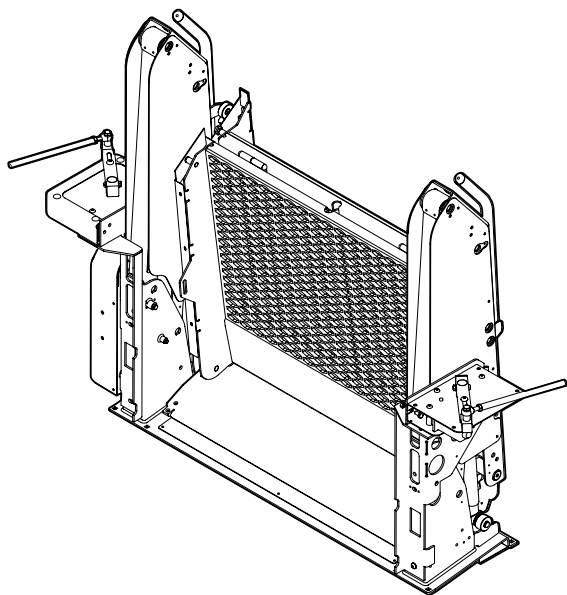

U3



U4

Mount the door opener with screws and nuts **U3** **U4** onto the bracket. .

Connection

handiRDO™

REAR DOOR OPENER

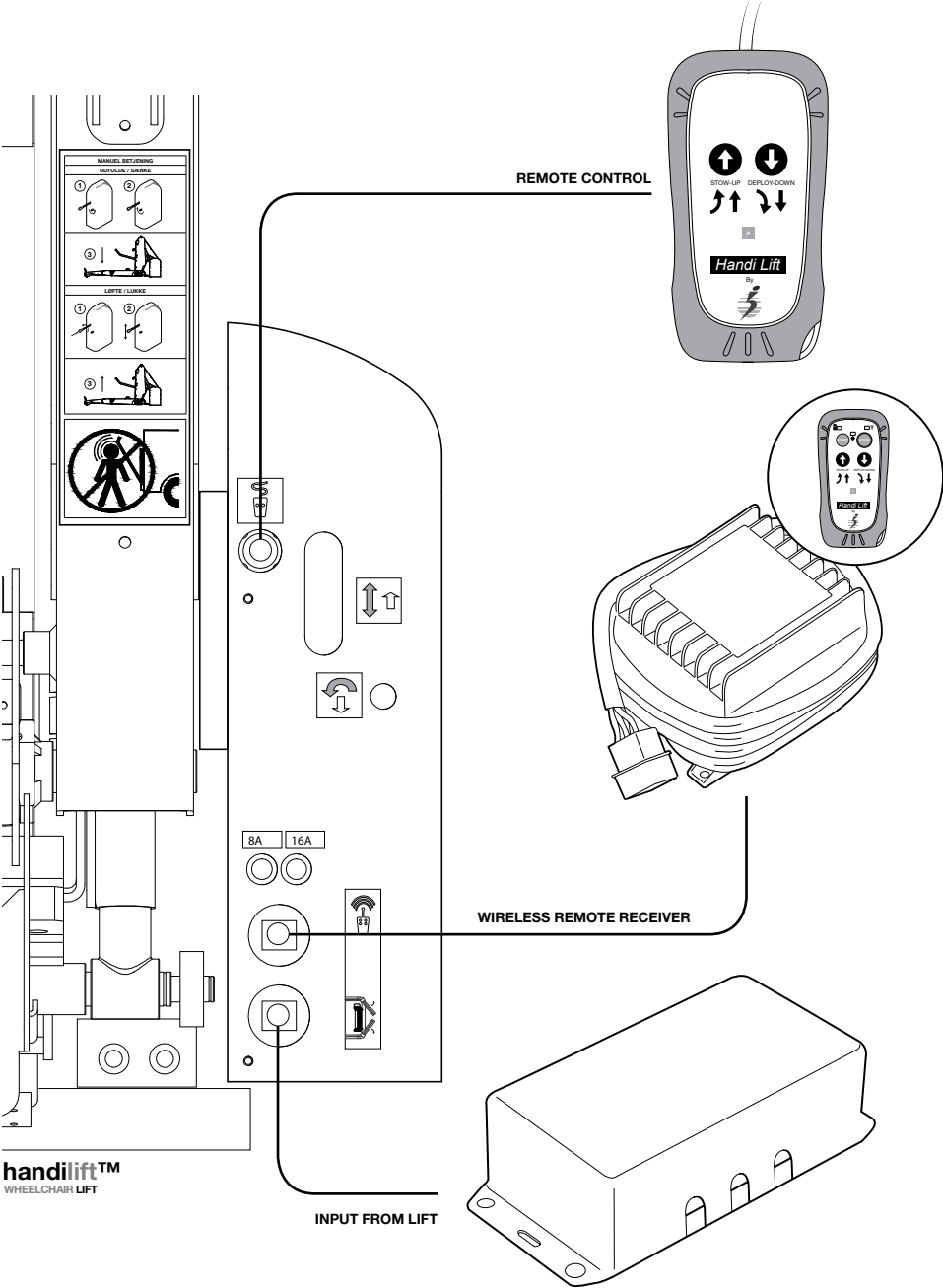

Connection

handiRDO™

REAR DOOR OPENER

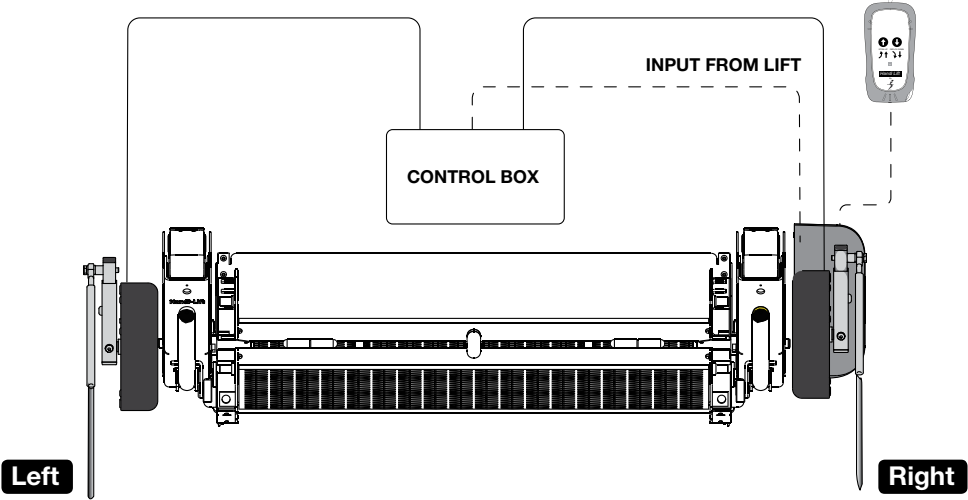

Control box

INPUT FROM LIFT CONNECTOR:

- Pin 1** - +12V Input for opening (green wire)
- Pin 2** - +12V Input for closing (yellow wire).
- Pin 3** - Ground Mass (black wire).
- Pin 4** - Ground output when door is fully opened.
- Pin 5** - +12 Volt.
- Pin 6** - +12 Volt output when door is fully opened.

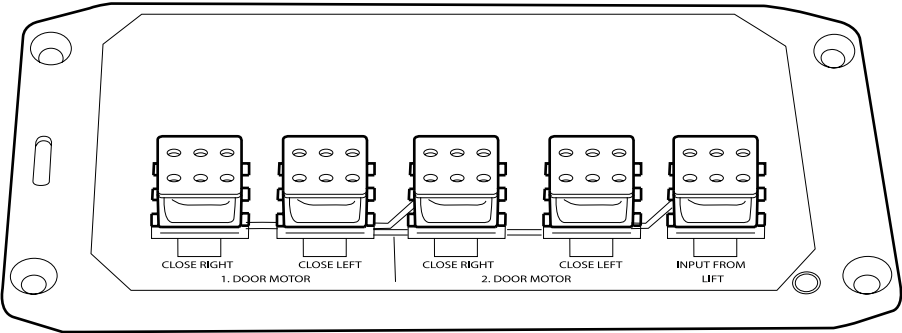

Connection

Vertical mounting

handiRDO™
REAR DOOR OPENER

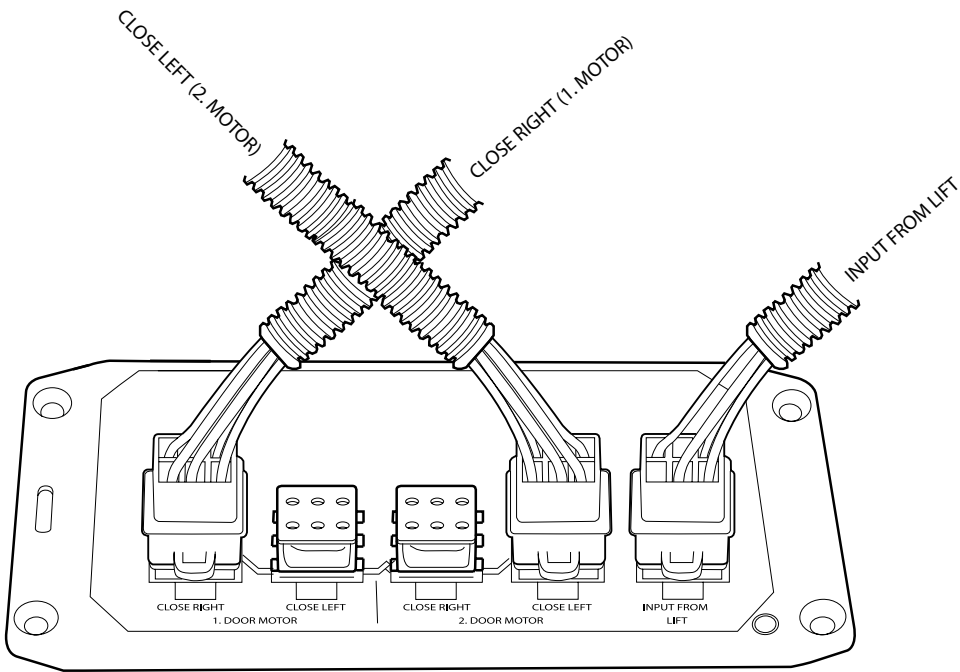
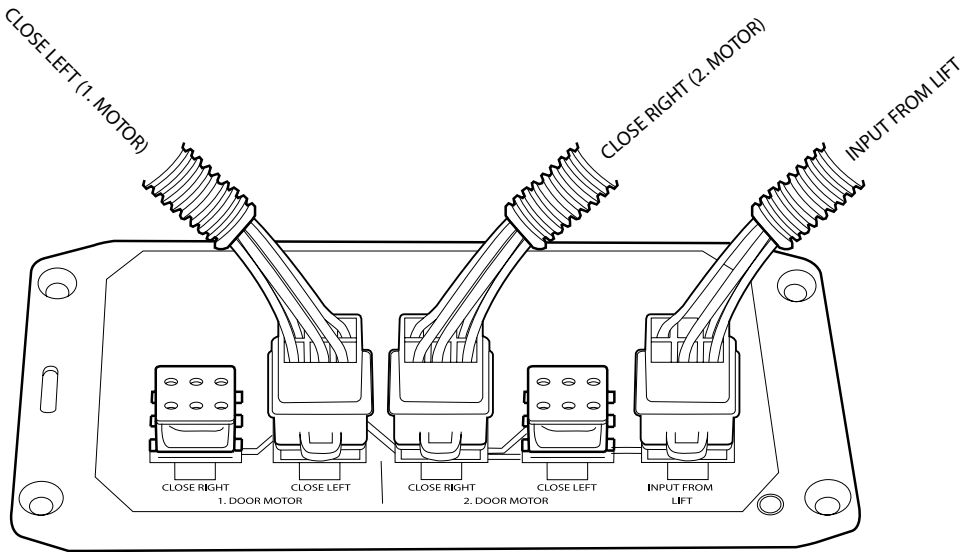

Connection

Horizontal mounting

handiRDO™
REAR DOOR OPENER

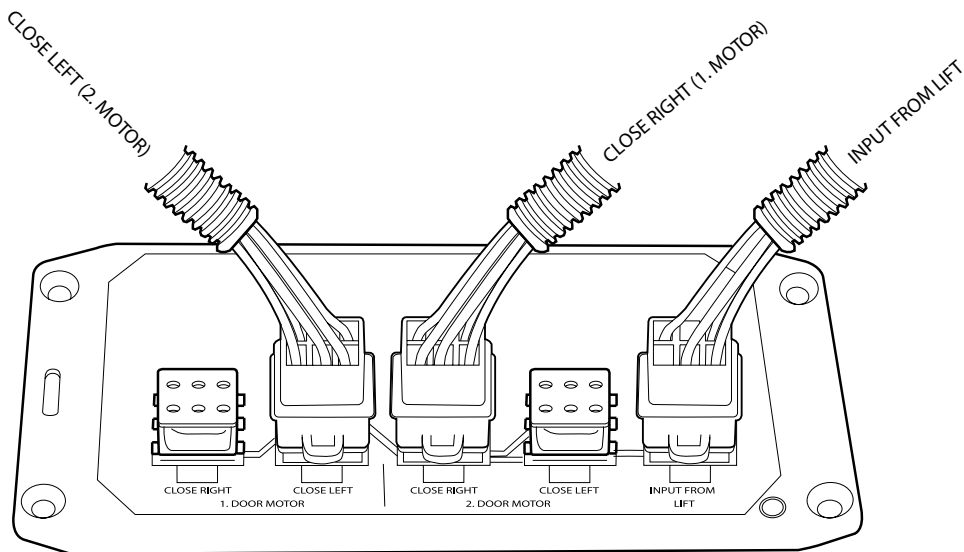
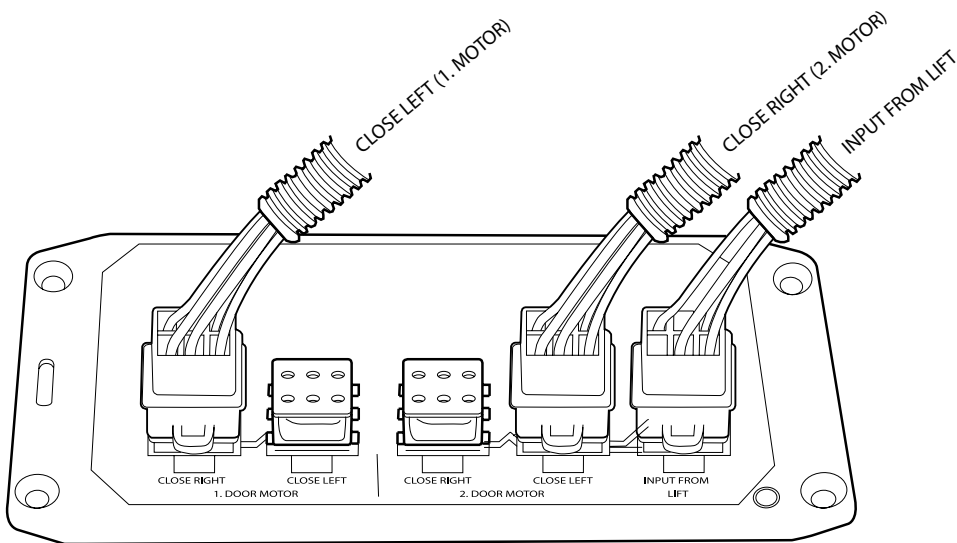

Adjustment

handiRDO™ REAR DOOR OPENER

The door openers opening and closing position can be timed by adjusting the triggers for the two sensors.

The position of the triggers are adjusted using a 10 mm wrench.

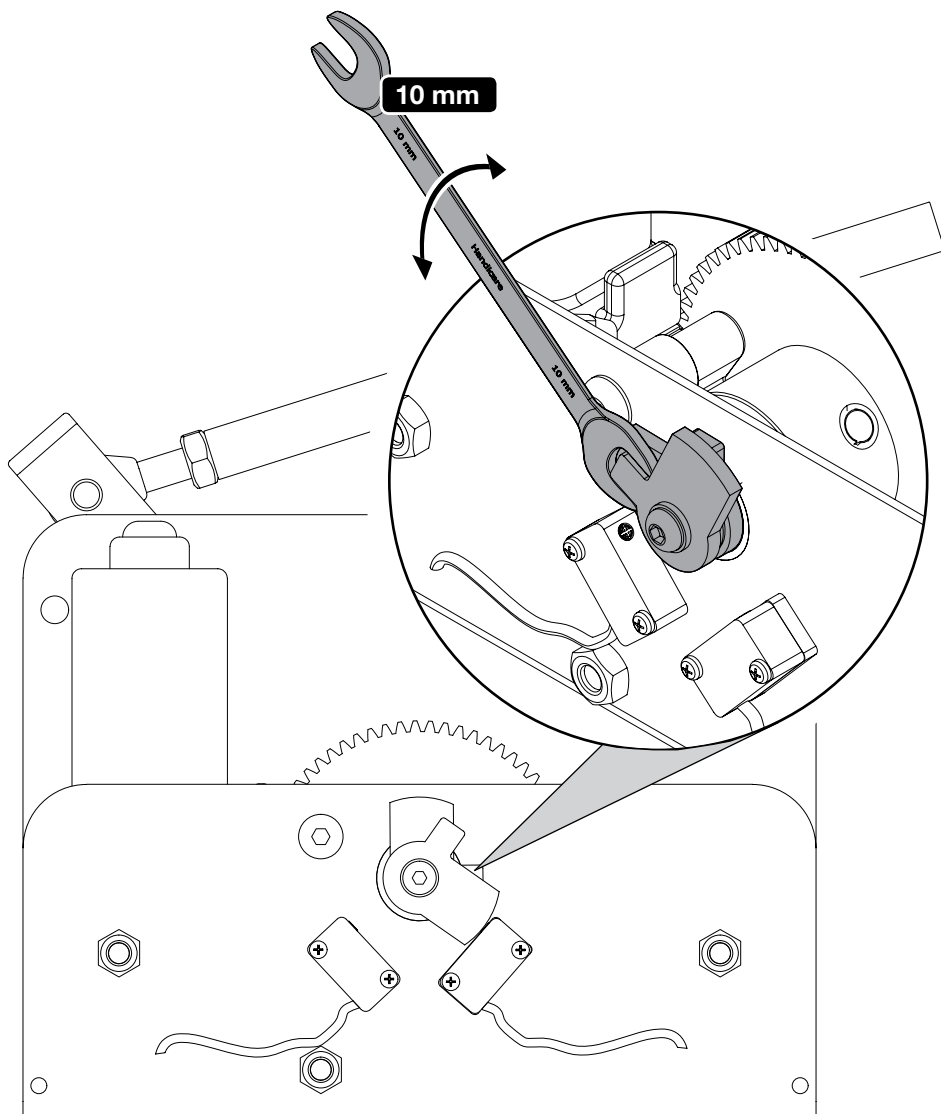

Adjustment

handiRDO™ REAR DOOR OPENER

The triggers are connected to the arm shaft, rotating in sync. A sensor on both sides registers when the trigger blocks it, turning it off or on. The start and stop sequence is controlled by

The start/end position can then be easily adjusted.

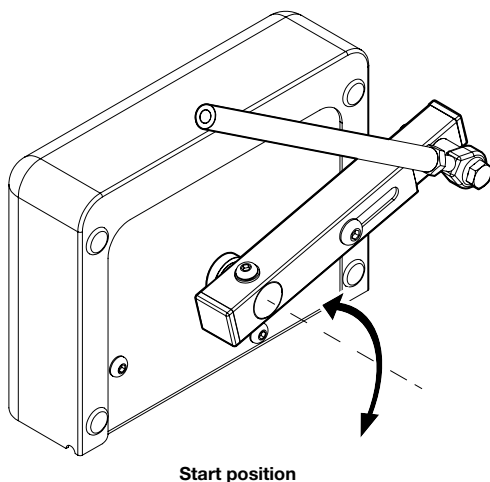
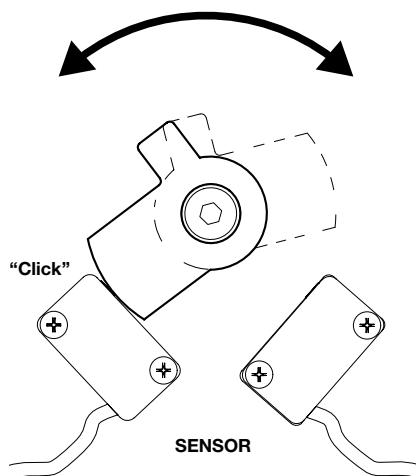
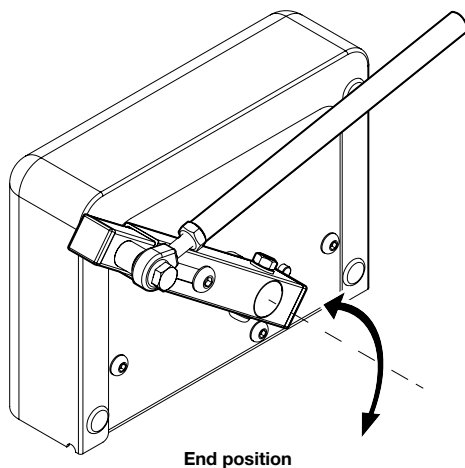
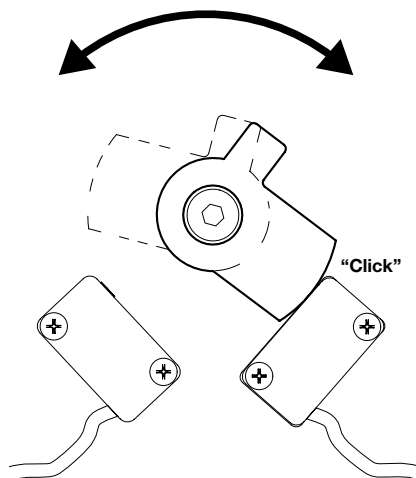

BRACKET KIT 61526

RENAULT MASTER | OPEL MOVANO | NISSAN INTERSTAR

handiRDO™

REAR DOOR OPENER

MMI



RENAULT
MASTER

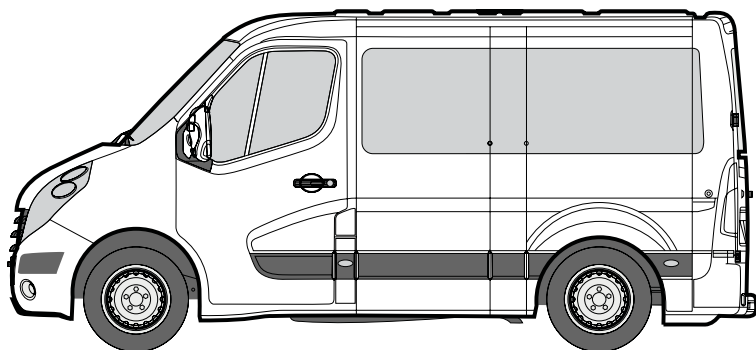

OPEL
MOVANO

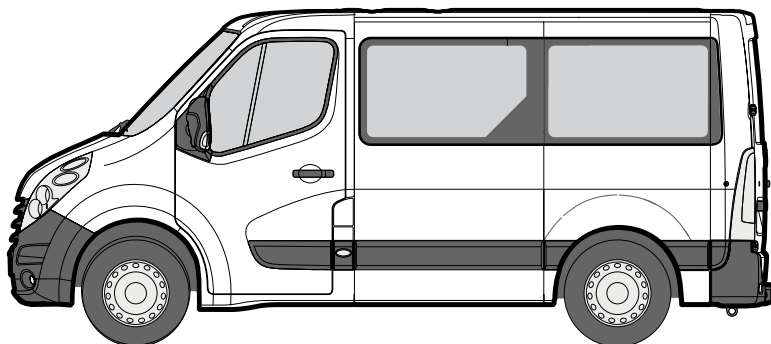

NISSAN
INTERSTAR

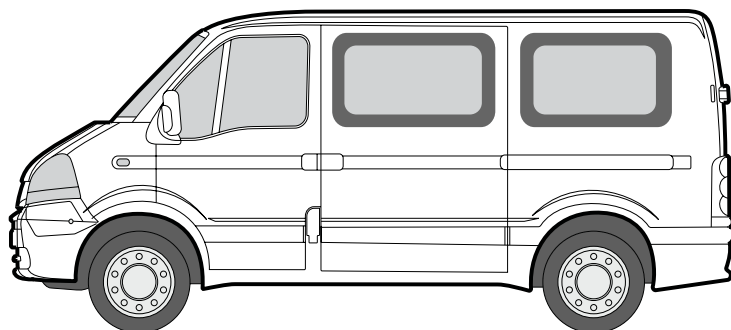

BRACKET KIT 61526

RENAULT MASTER | OPEL MOVANO | NISSAN INTERSTAR

handiRDO™

REAR DOOR OPENER

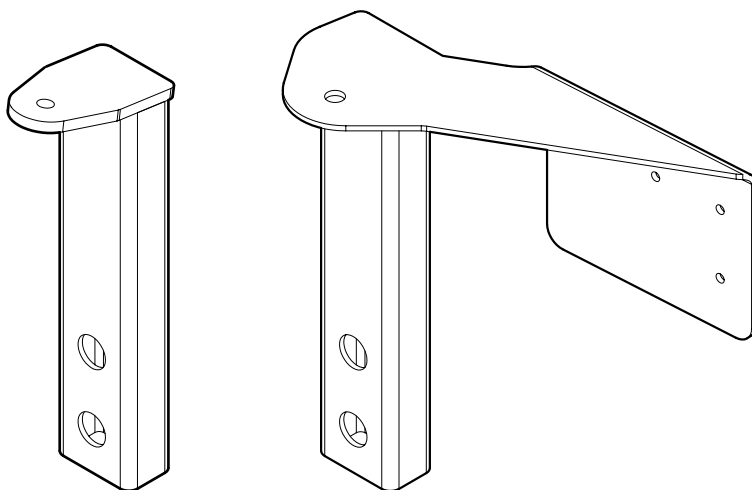

MMI1

MMI2

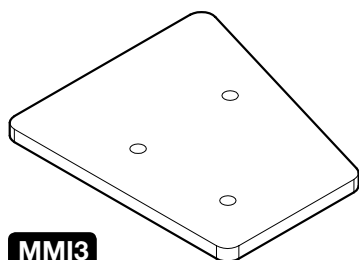
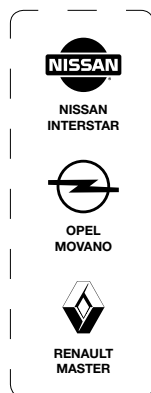

MMI3

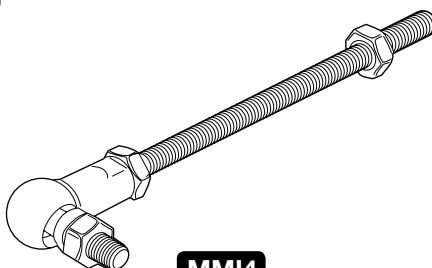

MMI4



MMI5

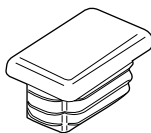

MMI6



MMI7

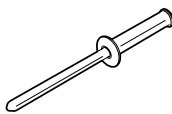

MMI8



MMI9



MMI10



MMI11

MMI1 1x Left door bracket

MMI2 1x Right door bracket

MMI3 1x Right door bracket (2)

MMI4 2x Ball joint

MMI5 2x Spacer

MMI6 2x Rectangular plug

MMI7 4x Round plug

MMI8 4x Pop rivet

MMI9 4x M8 Washer

MMI10 4x M8 Spring washer

MMI11 4x M8x30 Bolt

Mounting of door bracket

MMI - Right side

handiRDO™
REAR DOOR OPENER

1. The right inside door cover is removed.

2. Cut away the adhesive between the outside door and the two brackets to avoid dents when the door opener is attached.

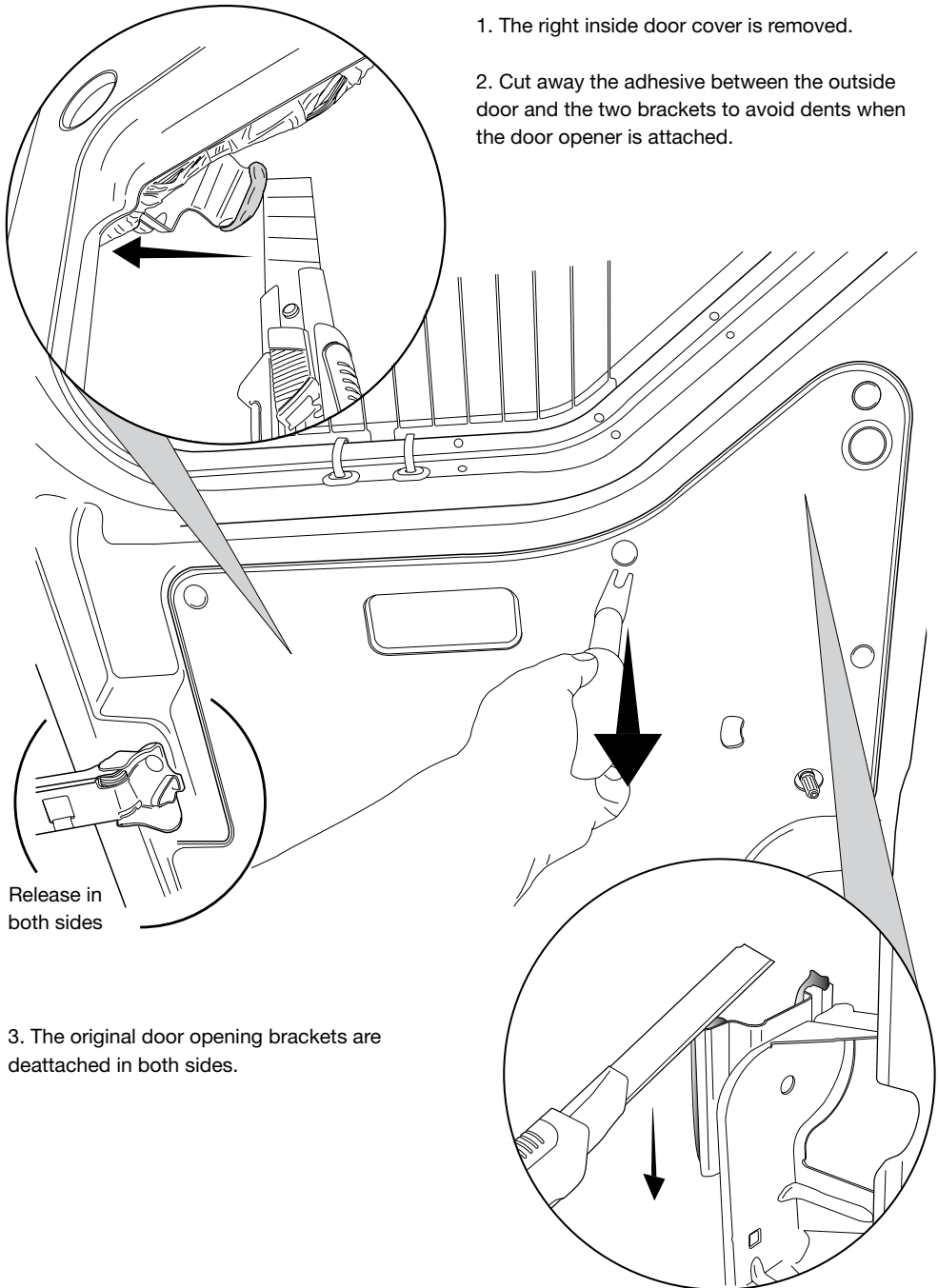

3. The original door opening brackets are deattached in both sides.

Mounting of door bracket

MMI - Right side

handiRDO™
REAR DOOR OPENER

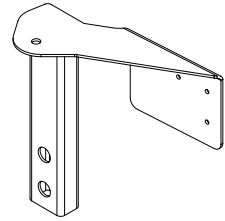
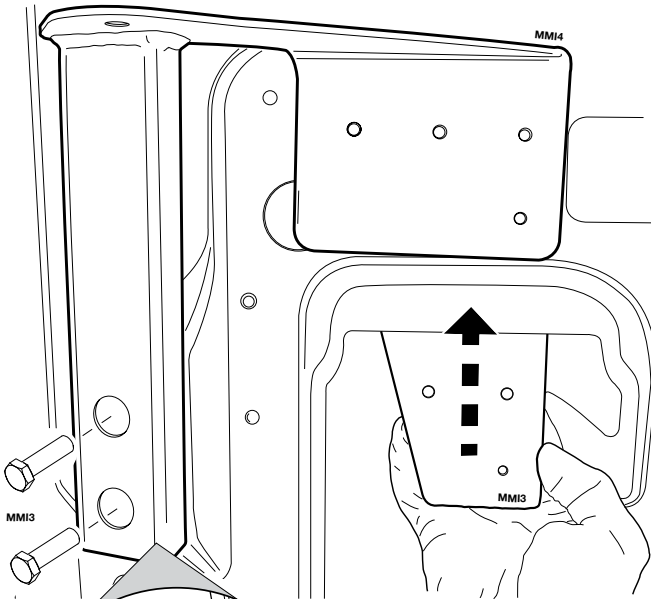

MMI2

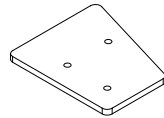

MMI3



MMI11

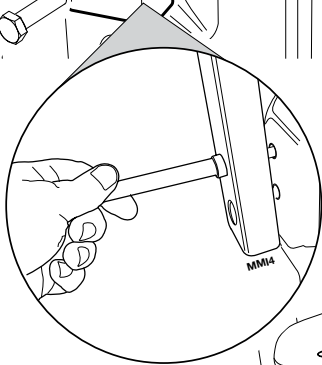

4. Bracket **MMI2** and **MMI3** are attached with bolts **MMI11**.

5. Drill the holes to Ø8 mm while **MM3** is fixed with a clamp.

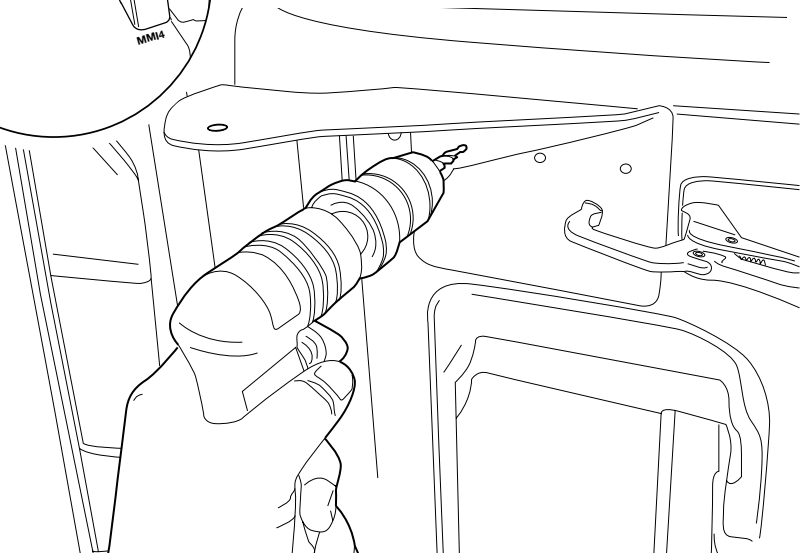

Mounting of door bracket

MMI - Right side

handiRDO™
REAR DOOR OPENER

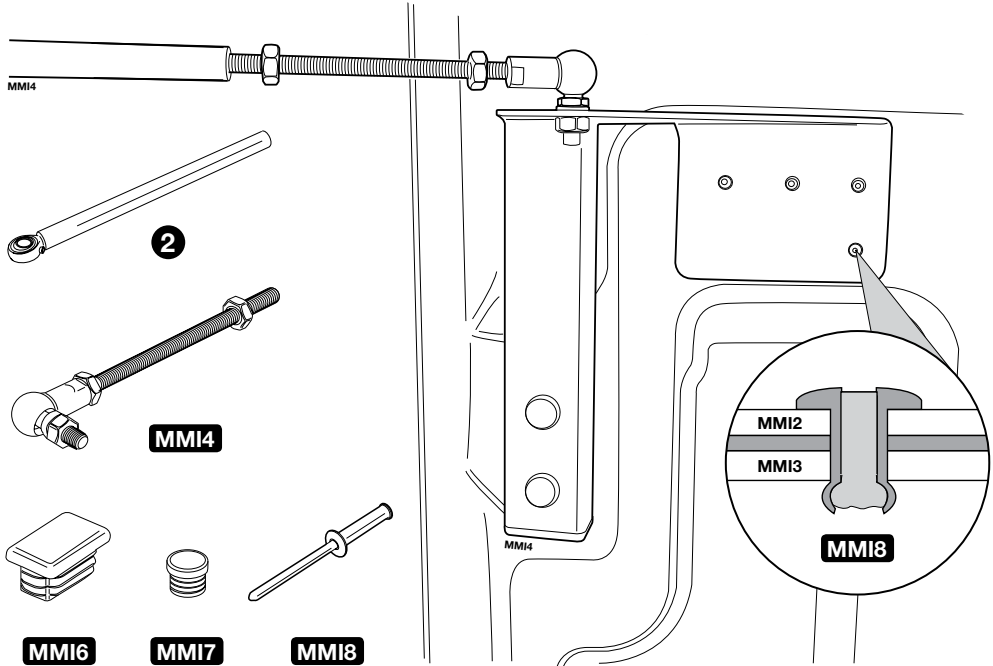

7. Bracket **MMI2** and **MMI3** are attached with pop rivets **MMI8**. Plug the openings with **MMI6** and **MMI7**.

Bottom plug, MM6, can be mounted before it is attached.

8. The door opener is connected to the bracket using the mounting rods **MMI2** and **MMI4**.

9. Spacer **MMI5** and release pin **3** is placed between mounting rod **2** and the door opener.

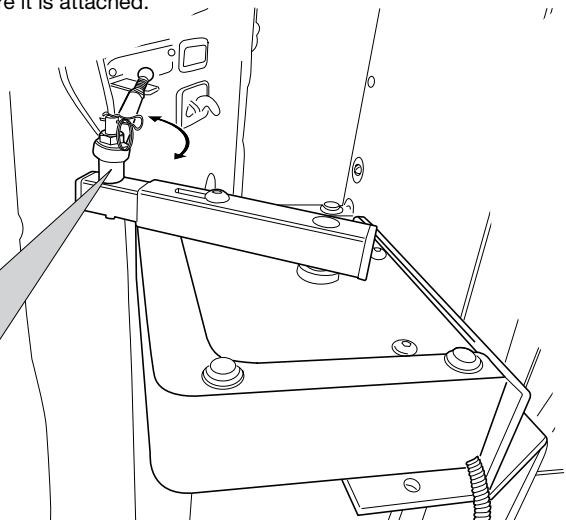
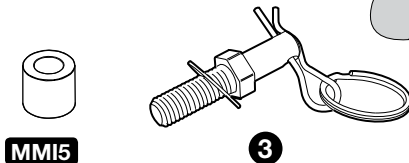

Mounting of door bracket

MMI - Left side

handiRDO™
REAR DOOR OPENER

10. Bracket **MMI1** is mounted with bolts **MMI11**. Plug the openings with **MMI6** and **MMI7**.
11. The door opener is connected to the bracket using the mounting rods **2** and **MMI4**.

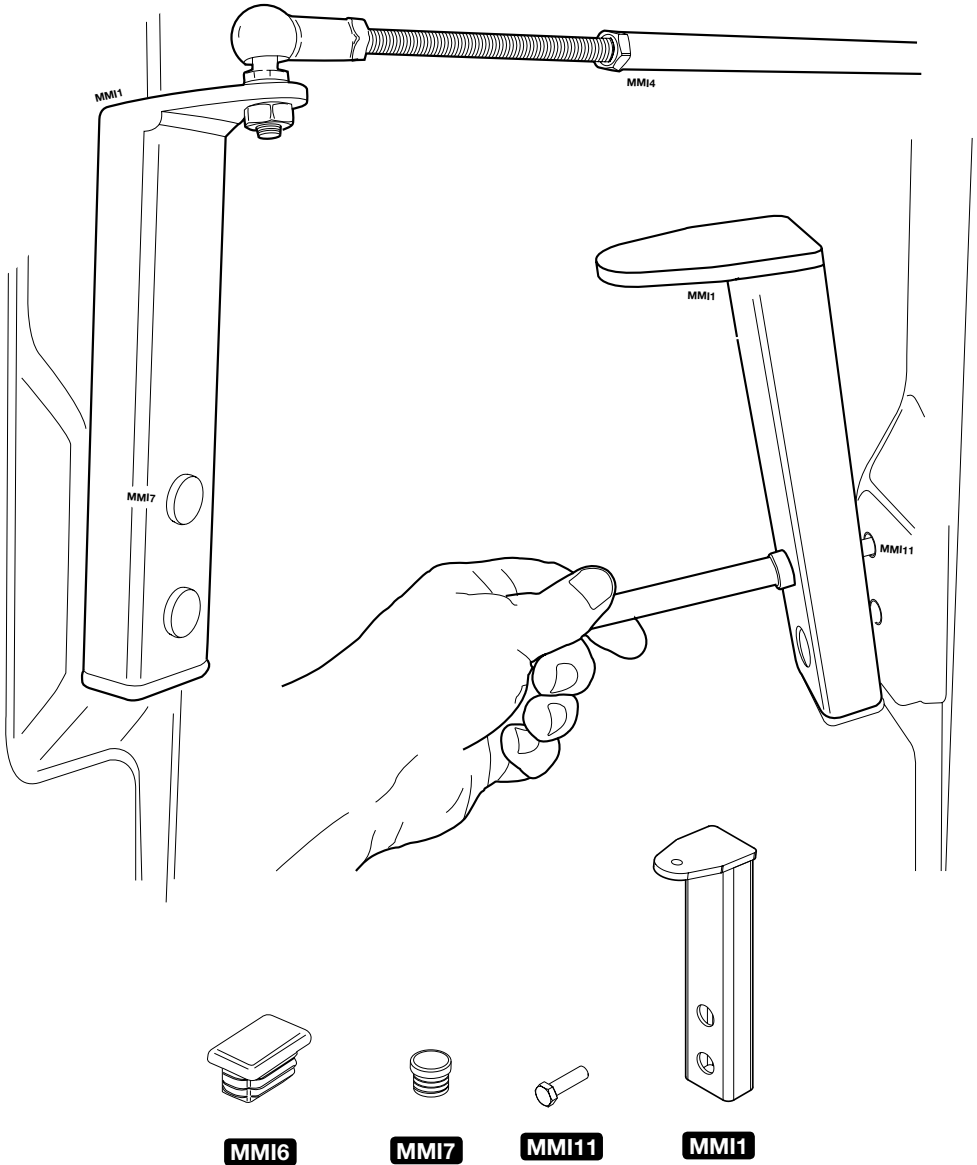

Adjustment of door opening handles

handiRDO™
REAR DOOR OPENER

12. The original door opening handles on both sides are blocked with a screw to keep them permanently “open”. Turn the handles to “open”, and then permanently fix the position with a screw.

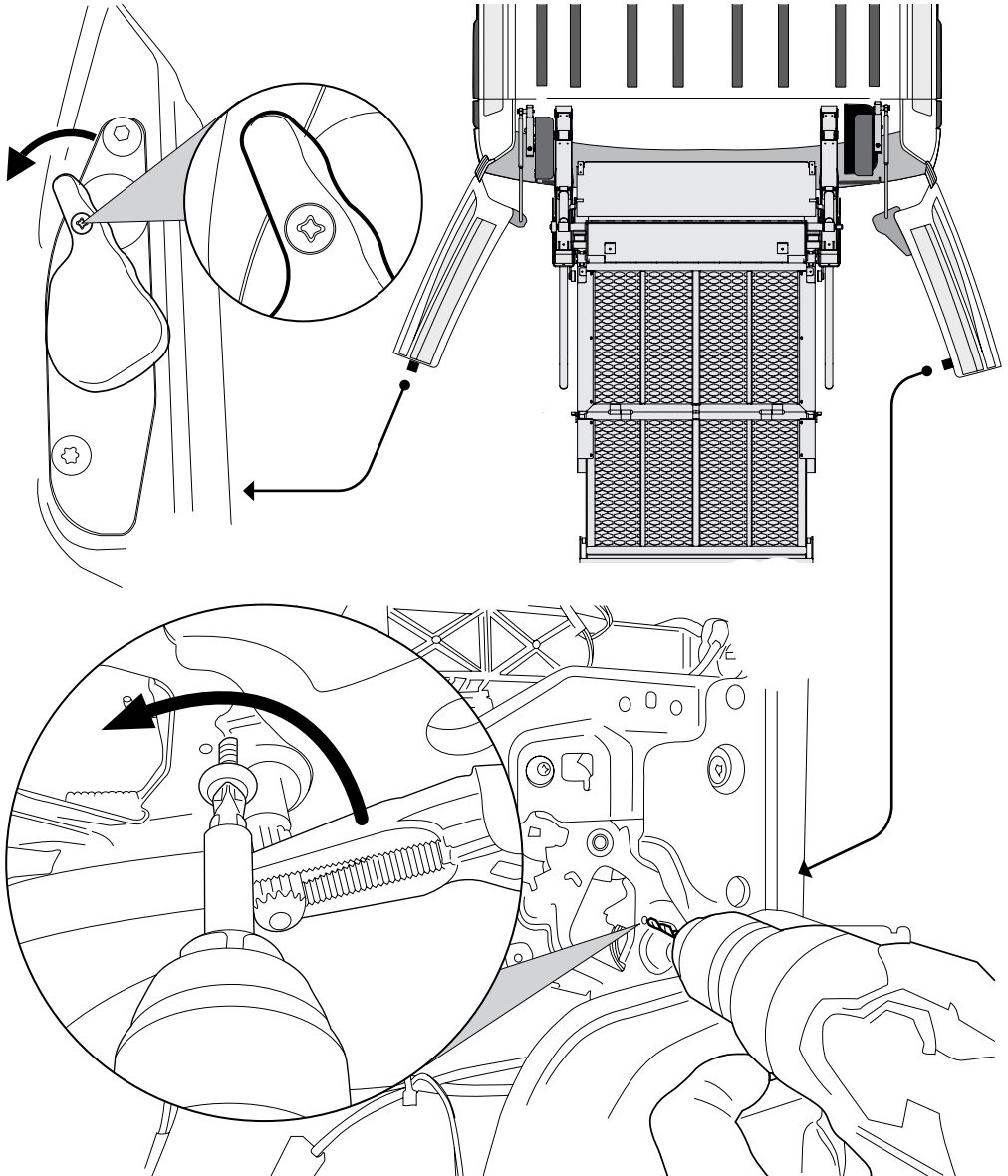



BRACKET KIT 61526

RENAULT MASTER | OPEL MOVANO | NISSAN INTERSTAR

handiRDO™

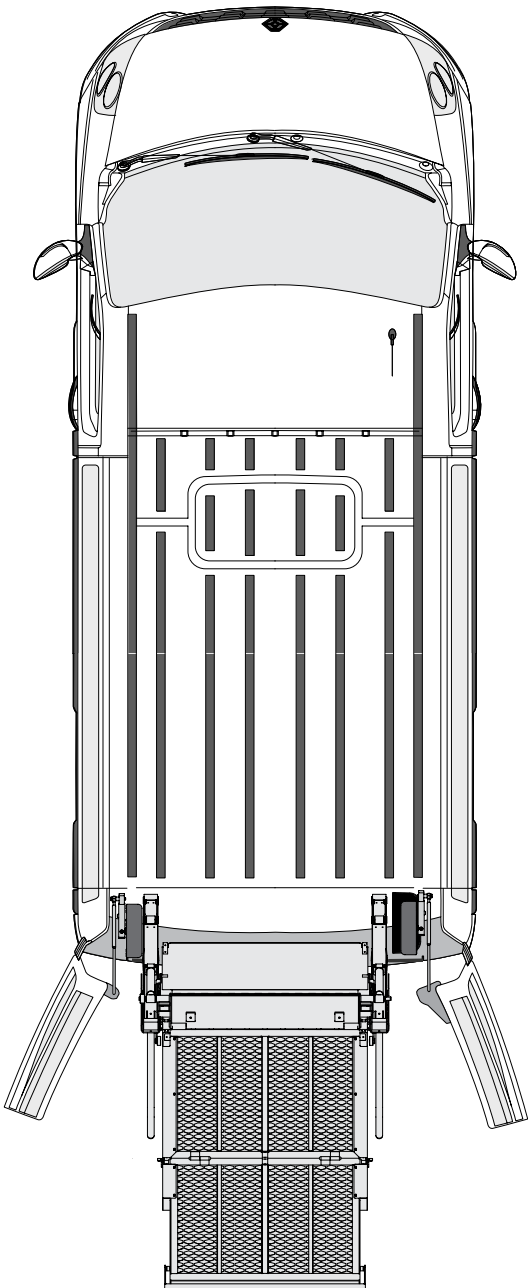
REAR DOOR OPENER





NISSAN
INTERSTAR



OPEL
MOVANO



RENAULT
MASTER

BRACKET KIT 61594

VW T5

handiRDO™

REAR DOOR OPENER



VW
T5

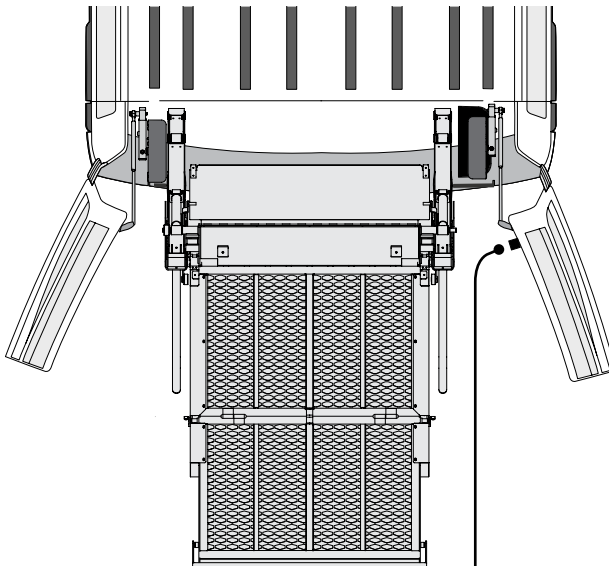
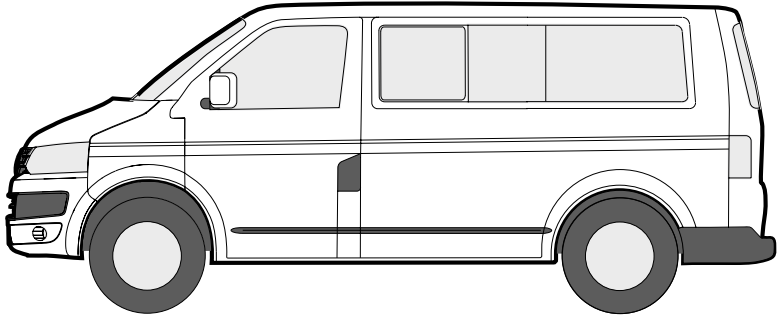

1, Page 39

Installation example is shown for the right door only. The procedure for the left door is identical.

BRACKET KIT 61594

VW T5

handiRDO™

REAR DOOR OPENER

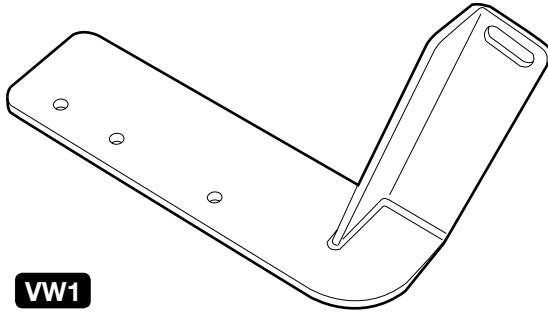

VW1

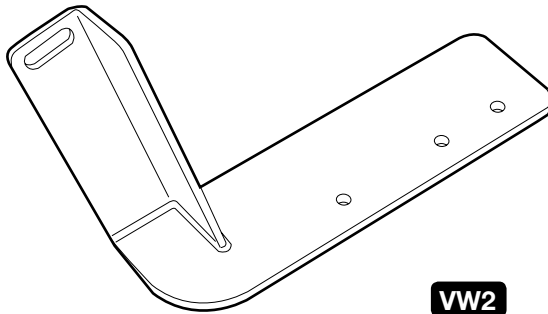

VW2

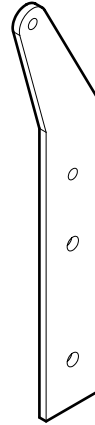

VW3

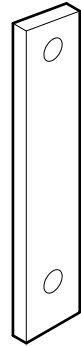

VW4

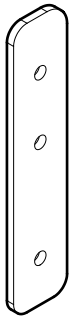

VW5

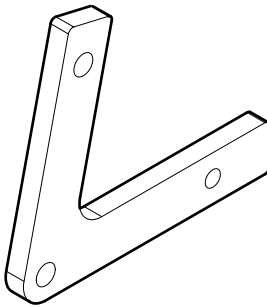

VW6

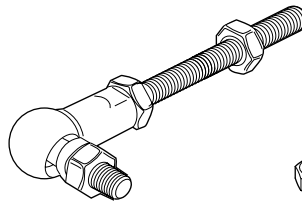

VW7



VW9



VW8



VW10

VW1 1x Left door bracket

VW2 1x Right door bracket

VW3 1x Right door bracket (2)

VW4 2x Bracket

VW5 2x Bracket

VW6 2x Bracket

VW7 2x Ball joints

VW8 4x M8 Nut

VW9 2x Spacer

VW10 6x M8x30

Mounting of door bracket

VW T5 - Right door

handiRDO™
REAR DOOR OPENER

1. The right inside door cover is removed.
2. Strip away the adhesive between the outside door and the small bracket with a wire to avoid dents when the door opener is operating.
3. Attach bracket **VW3** with bolts **VW10**.

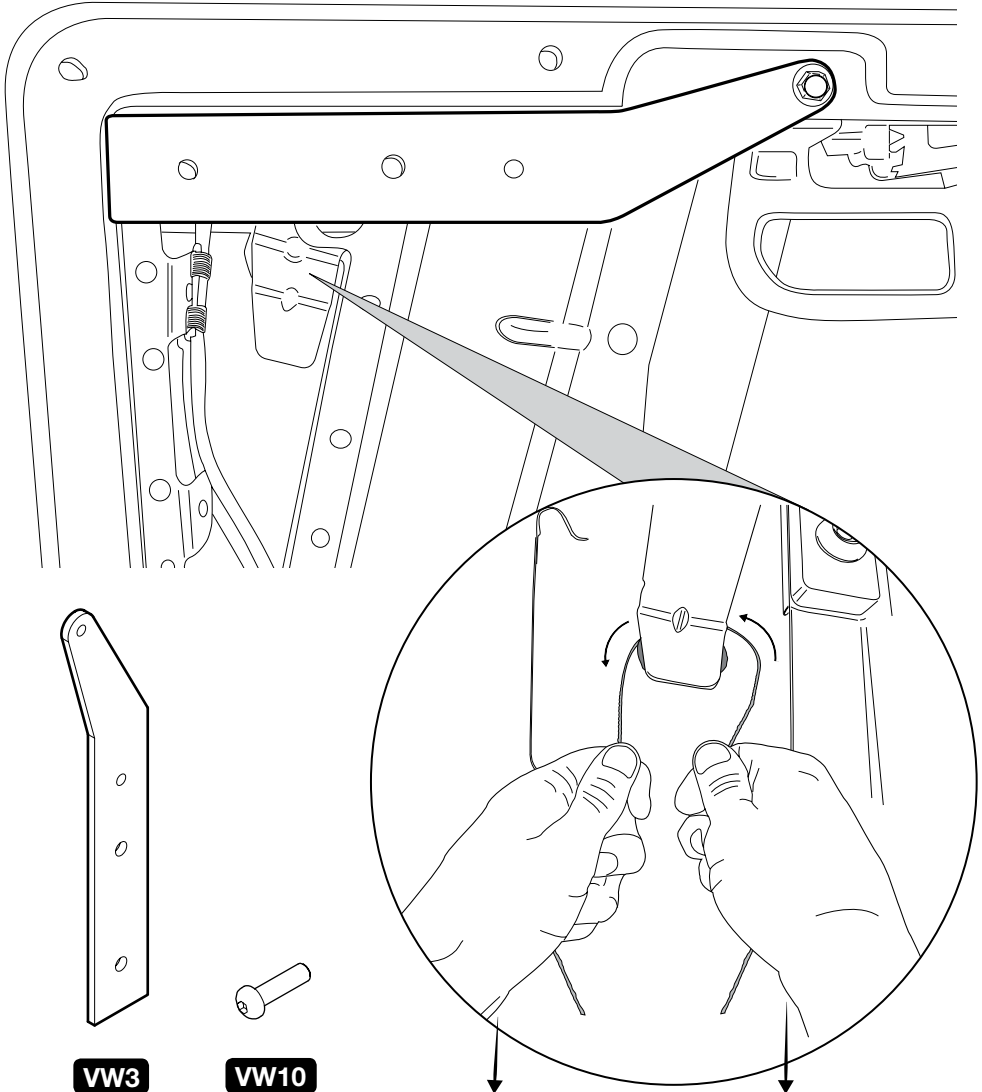

Mounting of door bracket

VW T5 - Right door

handiRDO™
REAR DOOR OPENER

4. Drill the holes to Ø8 mm and attach bracket **VW6** behind bracket **VW3** with bolts **VW10**.

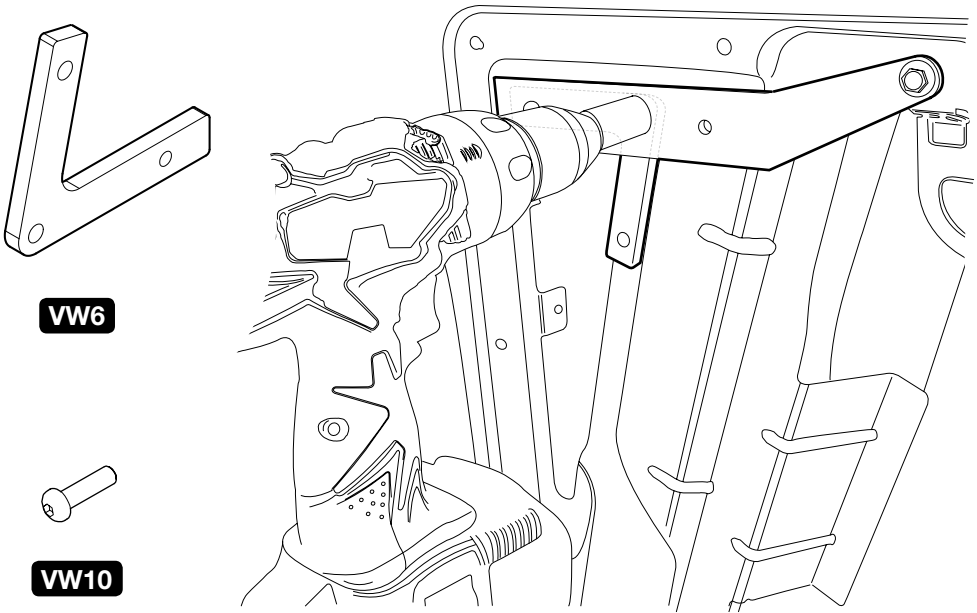

5. Drill the holes to Ø8 mm and attach bracket **VW4** behind bracket **VW3** with bolts **VW10**.

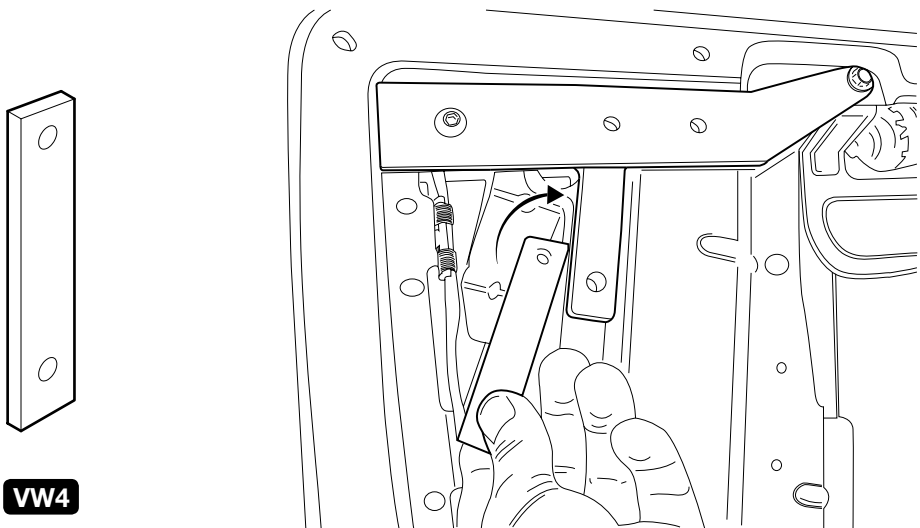

Mounting of door bracket

VW T5 - Right door

handiRDO™
REAR DOOR OPENER

6. Reattach the door cover and attach bracket **VW1** with just one bolt **VW10**, and slide it up behind so it is between the bracket and the door.

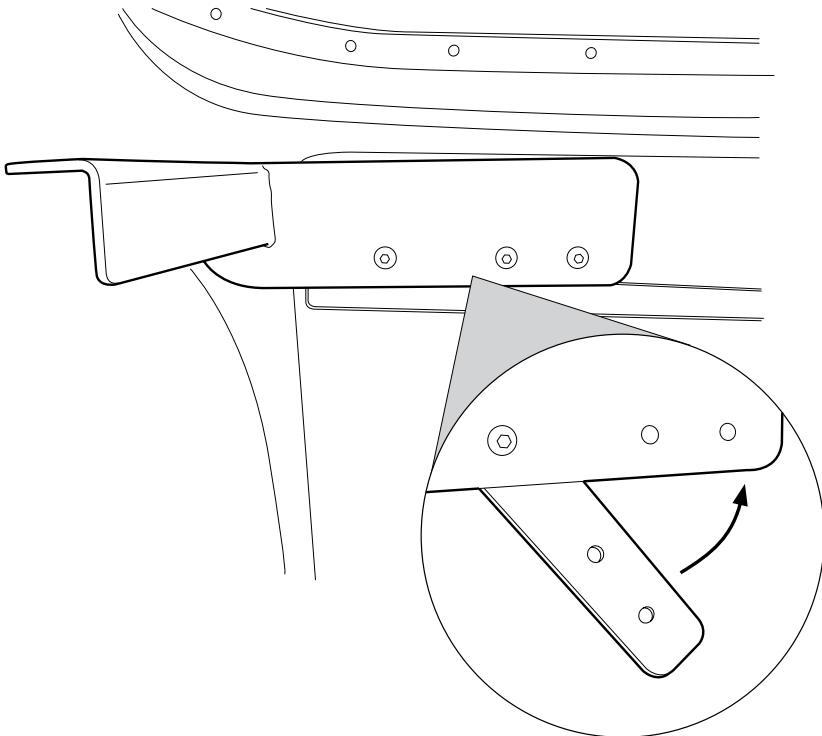
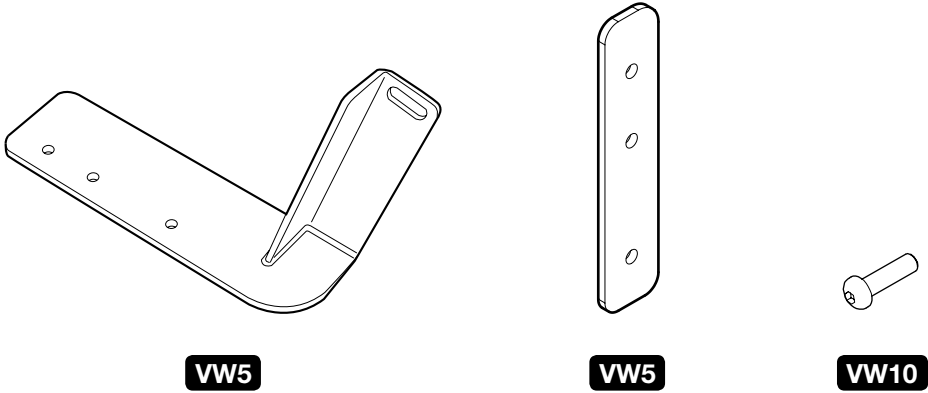

Mounting of door bracket

VW T5 - Right door

handiRDO™
REAR DOOR OPENER

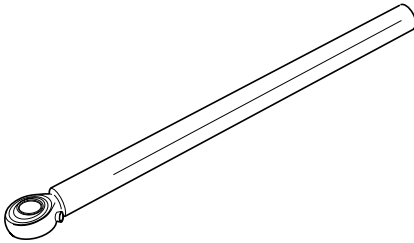

2

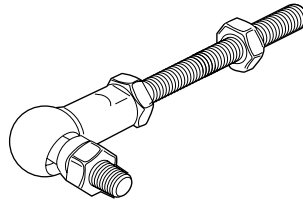

VW7



VW9

7. The door opener is connected to the bracket using the mounting rods **2** and **VW7**.
8. Spacer **VW9** and release pin **3** is placed between mounting rod **2** and the door opener.

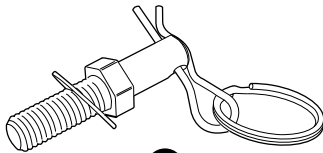

3

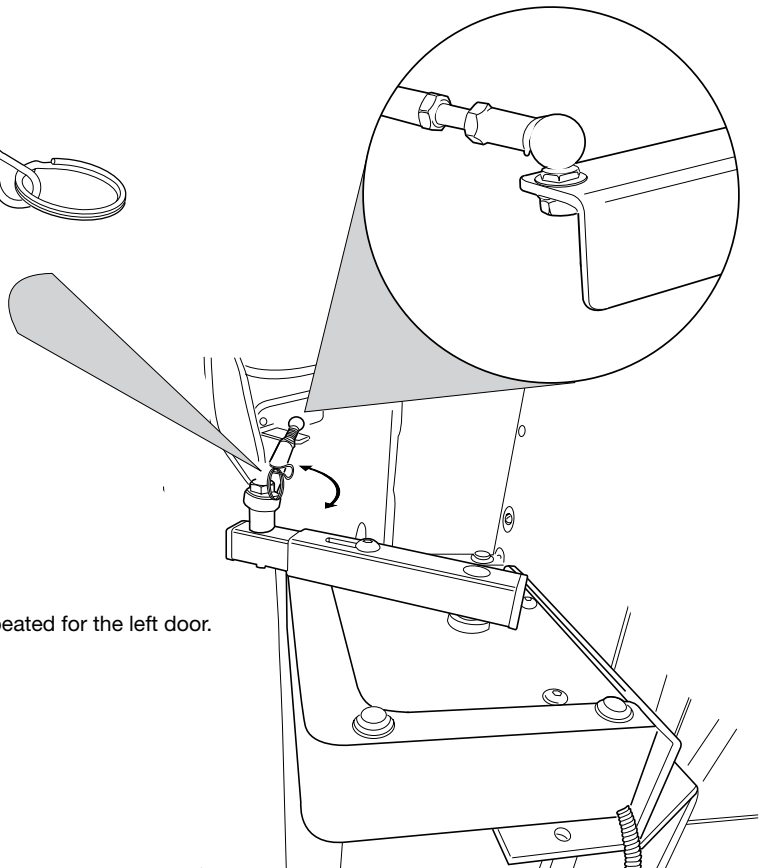

The procedure is repeated for the left door.

BRACKET KIT 61596

MERCEDES SPRINTER

handiRDO™

REAR DOOR OPENER



MERCEDES
SPRINTER

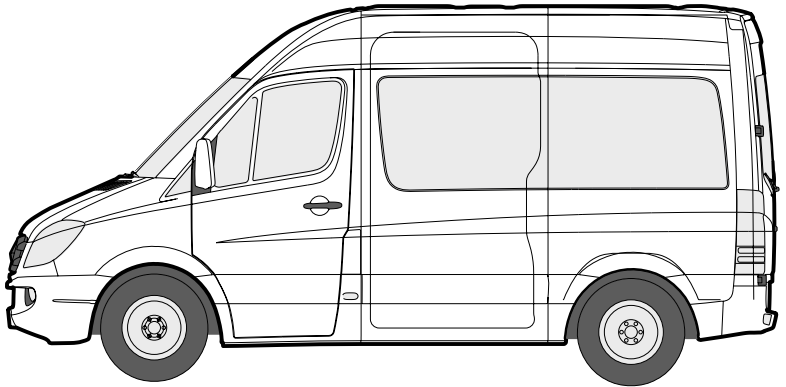

New bracket from 2018 -

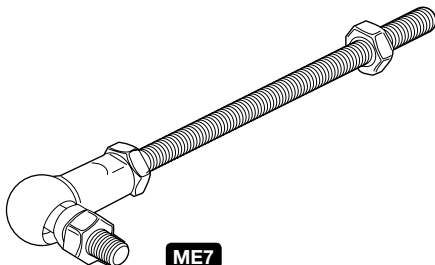
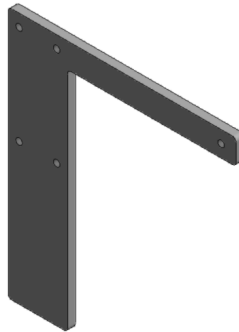
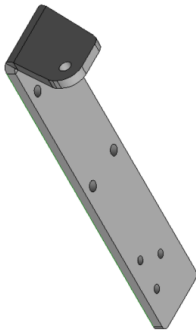

ME7

- | | |
|----------------------------------|---------------------------|
| ME1 1x Right door bracket | ME8 2x Ball joints |
| ME2 1x Left door bracket | ME9 2x Ball joints |
| ME3 2x Mounting plates | |
| ME4 2x Spacer | |
| ME5 6x M8x30 mm | |
| ME6 4x M8x30 mm | |
| ME7 2x M8 Nut | |

BRACKET KIT 61596

MERCEDES SPRINTER

handiRDO™

REAR DOOR OPENER

1. The original door opening brackets are released in both sides. They will be reattached later.

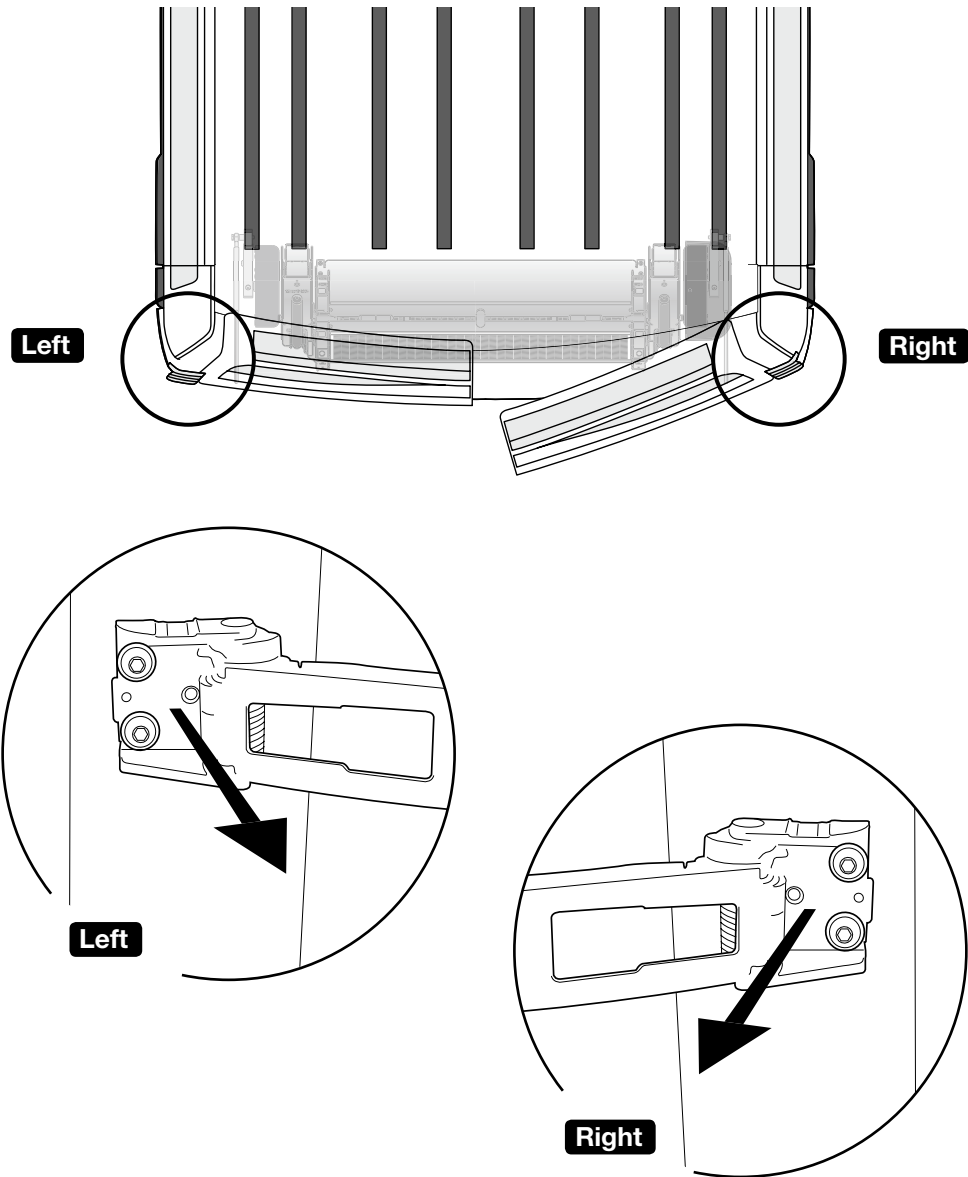

Mounting of door bracket

Mercedes Sprinter - Left door

handiRDO™
REAR DOOR OPENER

Manual for MB Sprinter is not complete in this manual. Contact Autoproducts for more information.

Mounting of door bracket

Mercedes Sprinter - Left door

handiRDO™
REAR DOOR OPENER

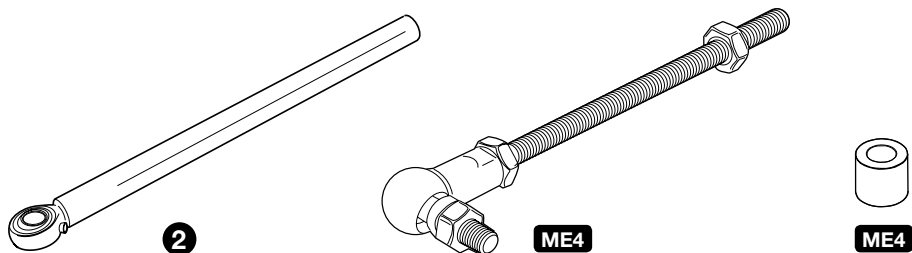

5. The door opener is connected to the bracket using the mounting rods **2** and **ME4**.
6. Spacer **ME4** and release pin **3** is placed between mounting rod **2** and the door opener.

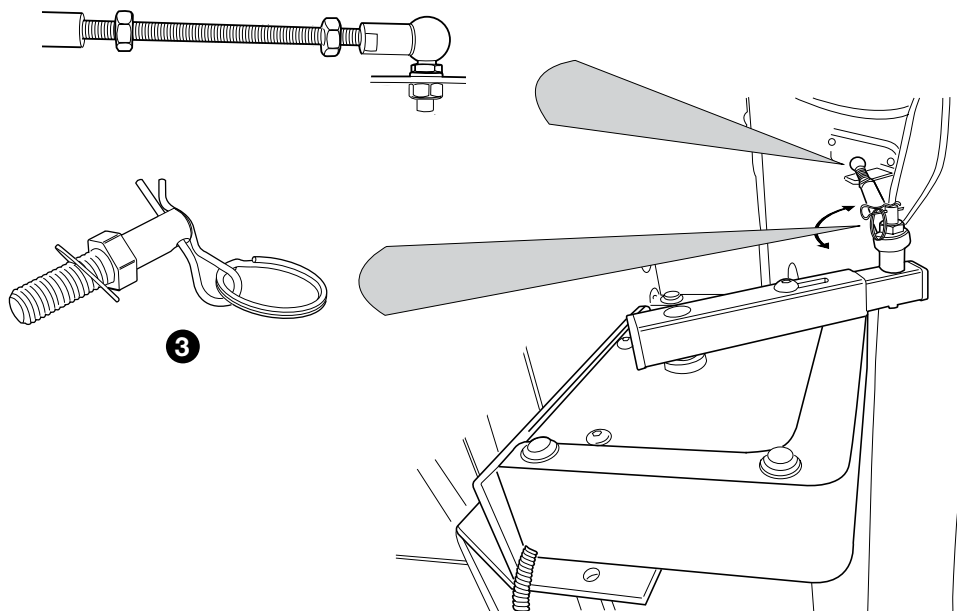

The procedure is repeated for the right door.

BRACKET KIT 61599

Mercedes Vito / Viano

handiRDO™

REAR DOOR OPENER



**MERCEDES
VITO / VIANO**

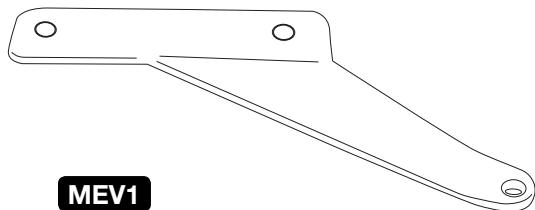
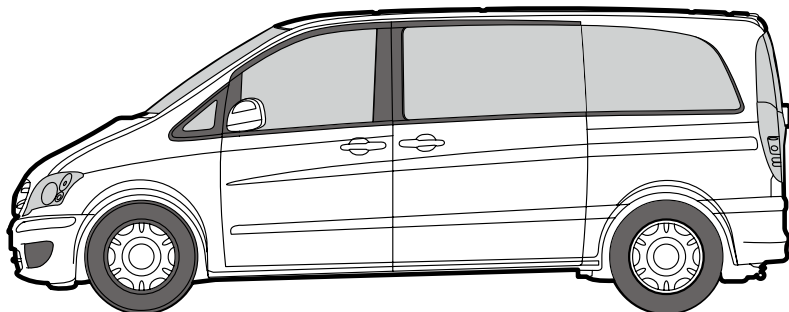

MEV1

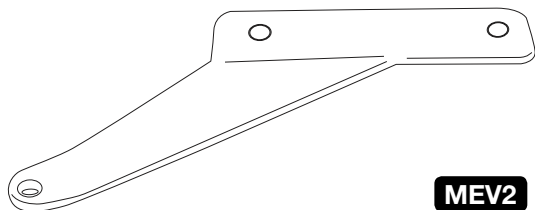

MEV2

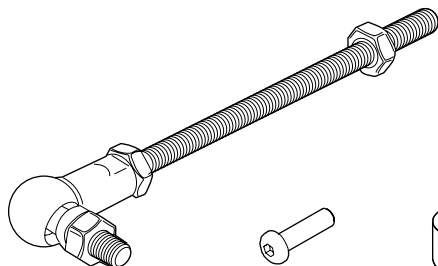

MEV3



MEV4



MEV5



MEV6

MEV1 1x Left door bracket

MEV2 1x Right door bracket

MEV3 2x Ball joints

MEV4 4x M8x30

MEV5 2x Spacer

MEV6 2x Spacer

Mounting of door bracket

Mercedes Vito / Viano - Left door

handiRDO™
REAR DOOR OPENER

1. The left inside door cover is removed, and two holes of Ø30 mm are drilled

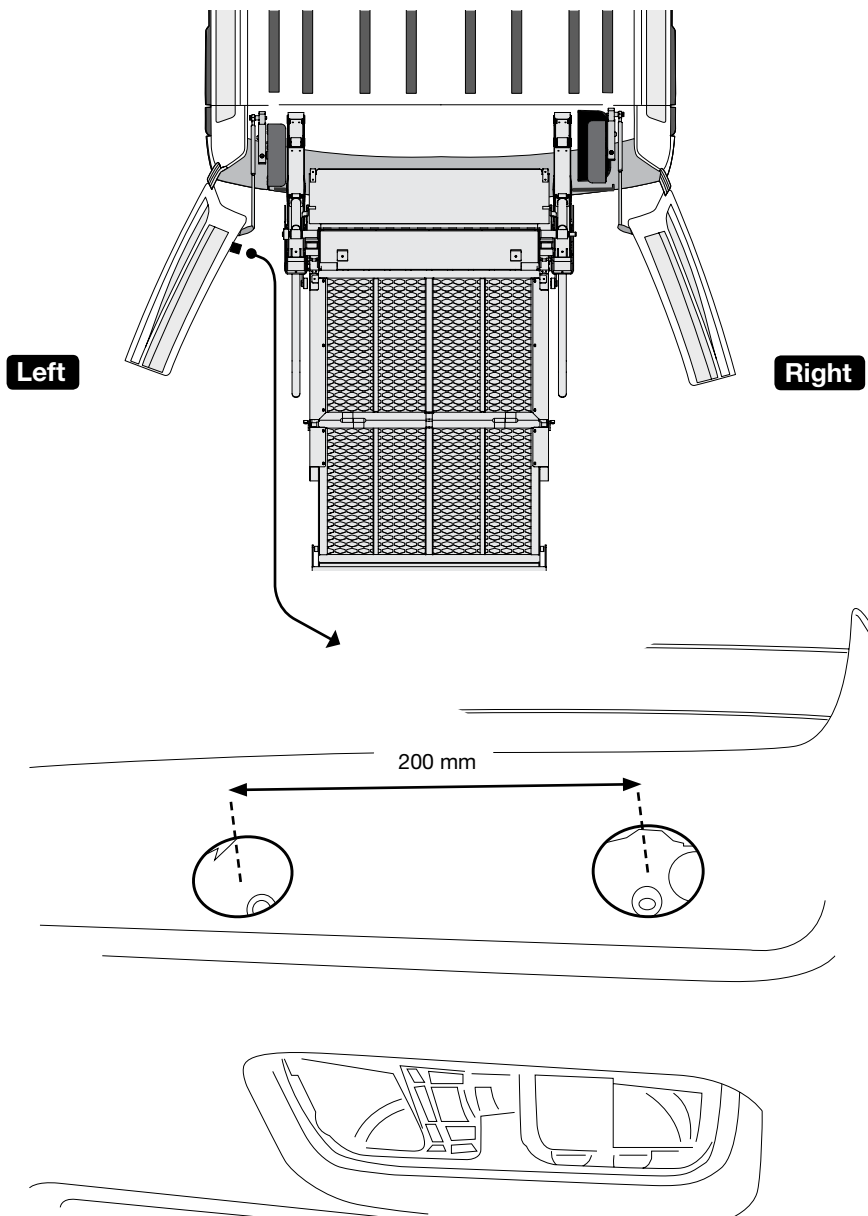

Mounting of door bracket

Mercedes Vito / Viano - Right door

handiRDO™
REAR DOOR OPENER

2. Spacer **MEV6** is placed in the holes (loose).



MEV6

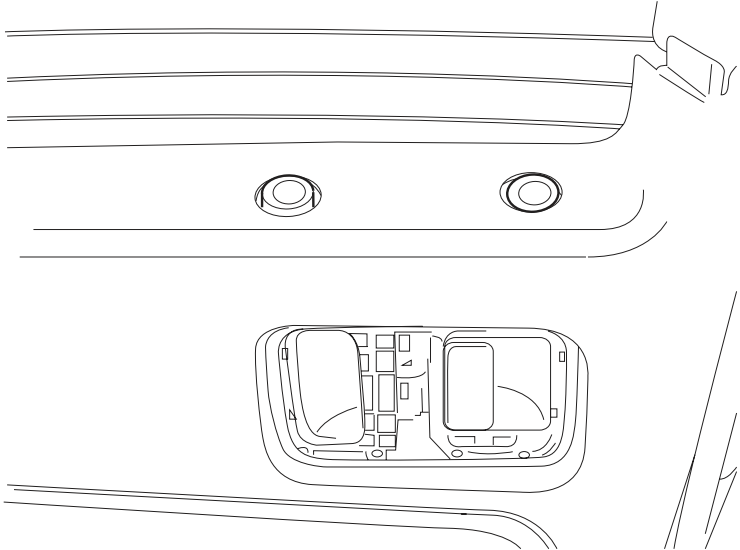

3. Bracket **MEV1** is attached with bolts **MEV4**.

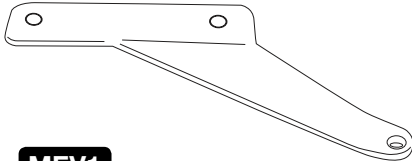

MEV1



MEV4

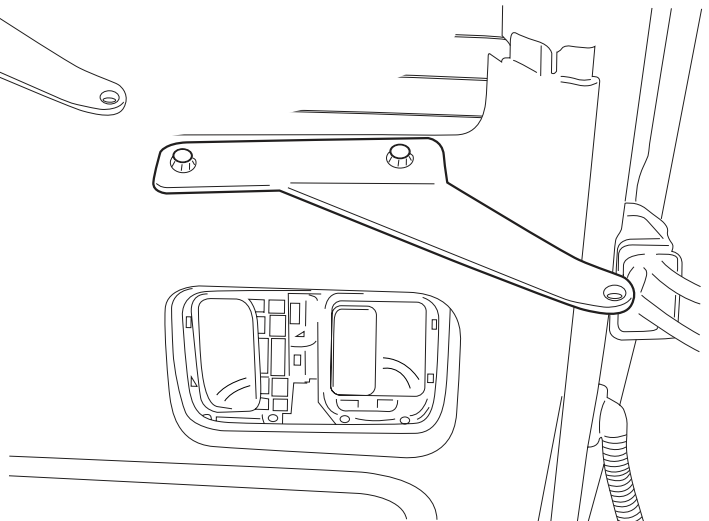

Mounting of door bracket

Mercedes Vito / Viano - Right door

handiRDO™
REAR DOOR OPENER

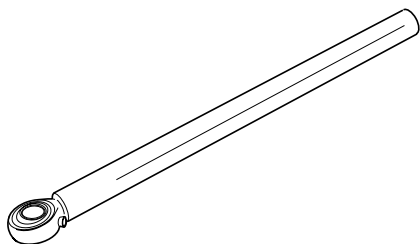

2

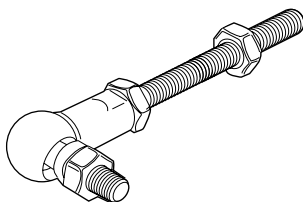

MEV3



MEV4

7. The door opener is connected to the bracket using the mounting rods **2** and **VW7**.

8. Spacer **VW9** and release pin **3** is placed between mounting rod **2** and the door opener.

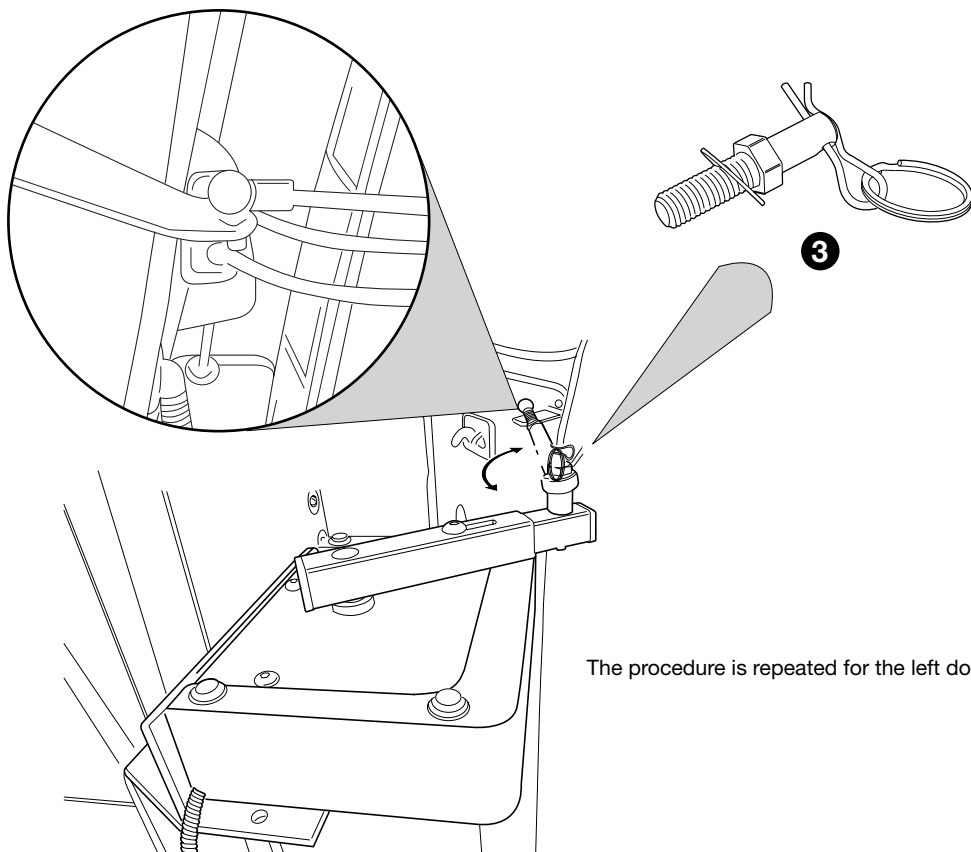

The procedure is repeated for the left door.

User guide

handiRDO™ REAR DOOR OPENER

Opening

1. Press and hold the button  to open the rear doors.



WARNING: Keep a safe distance when operating the RDO and lift!

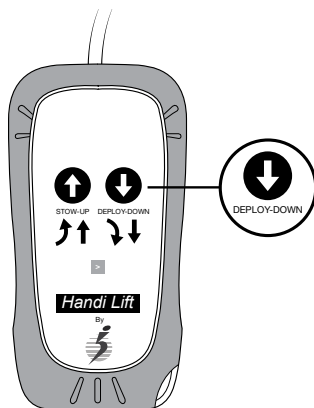
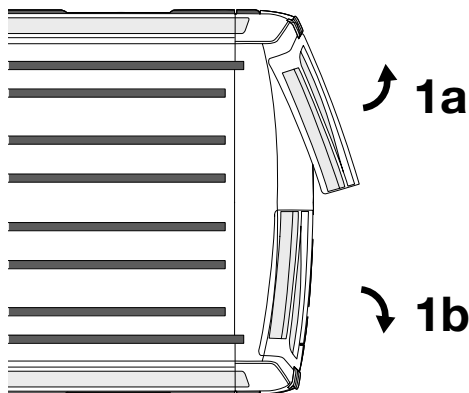

2. Continue pressing the button  to activate the wheelchair lift.

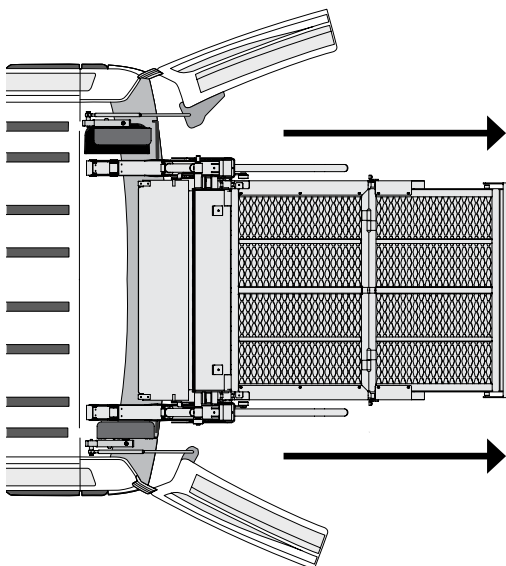

2

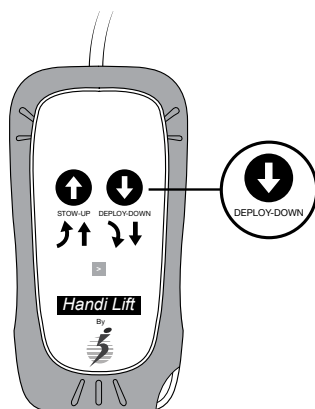



User guide

handiRDO™
REAR DOOR OPENER

Closing

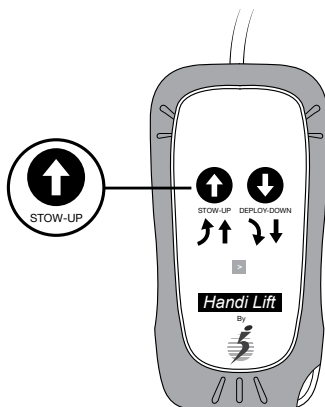
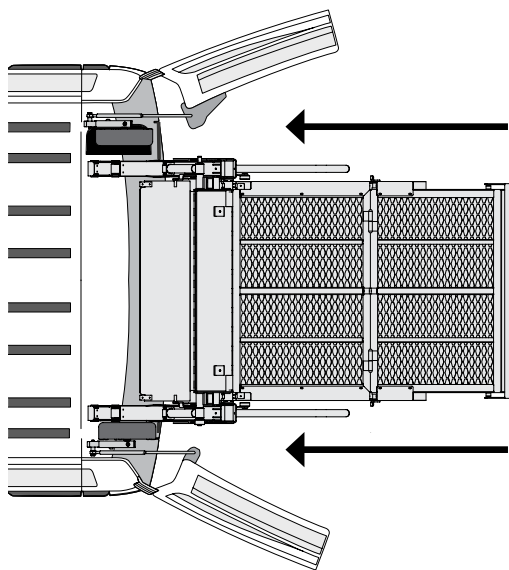
1. Press and hold the button  to stow the lift and close the rear doors.



2. Continue pressing the button . When a small safety-delay occurs, keep pressing to close the doors completely.

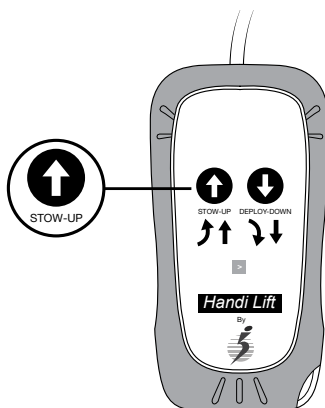
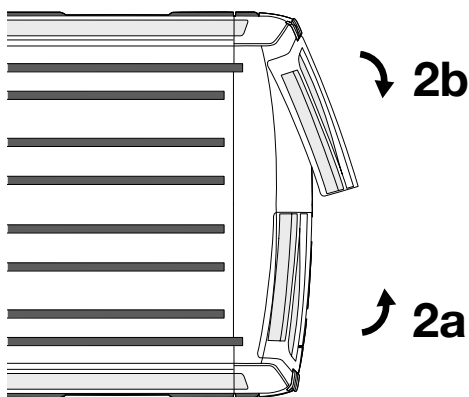

User guide for wireless control

Opening

1. Press the button  to activate the RDO.
2. Press and hold the button  to open the rear doors.

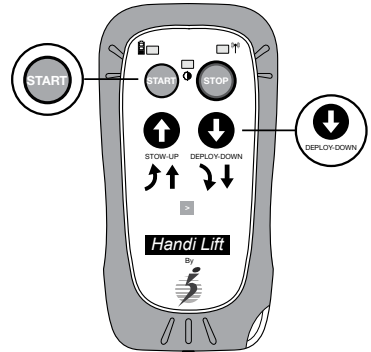
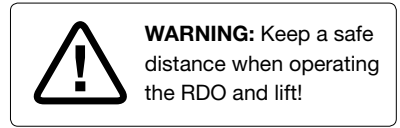
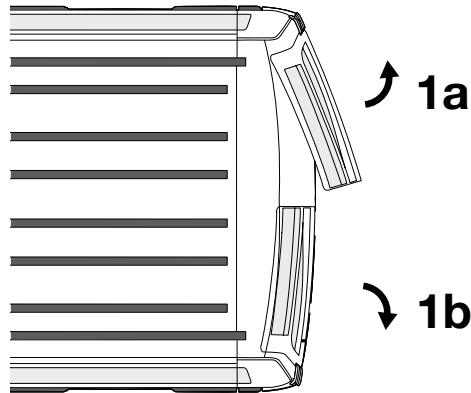

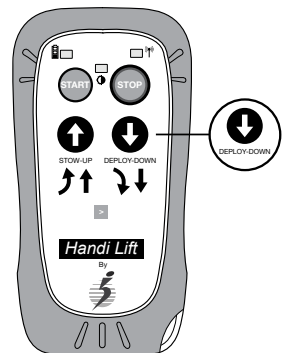
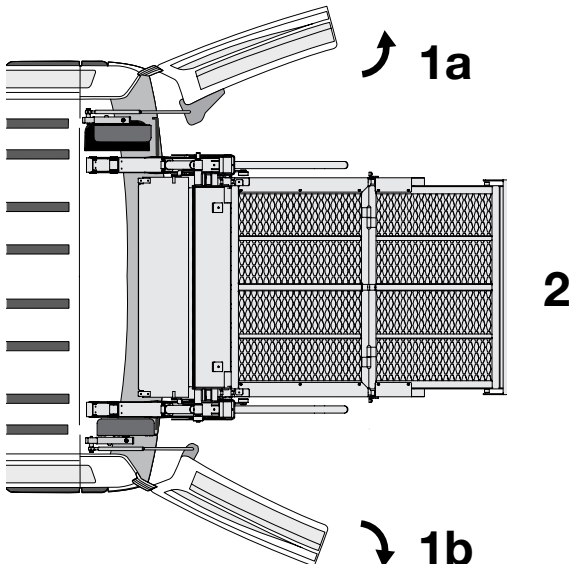

2. Continue pressing the button  until the vehicle doors are fully open and the wheelchair lift is completely unfolded.



User guide for wireless control

Closing

1. Press the button  to activate the RDO.
2. Press and hold the button  to stow the lift and close the rear doors.

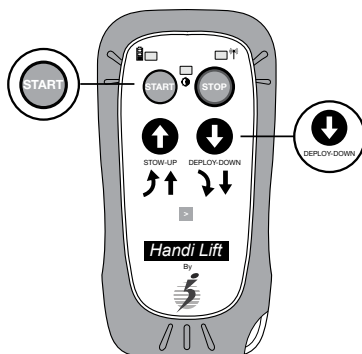
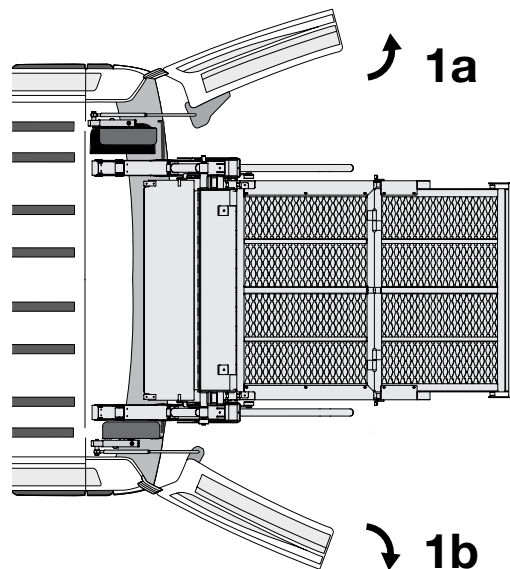

2. Continue pressing the button . When a small safety-delay occurs, keep pressing to close the doors completely.

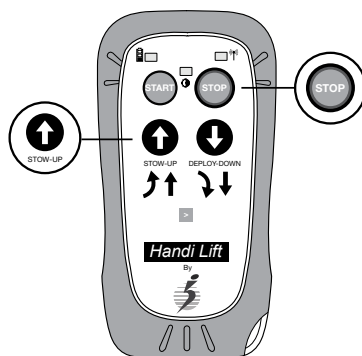
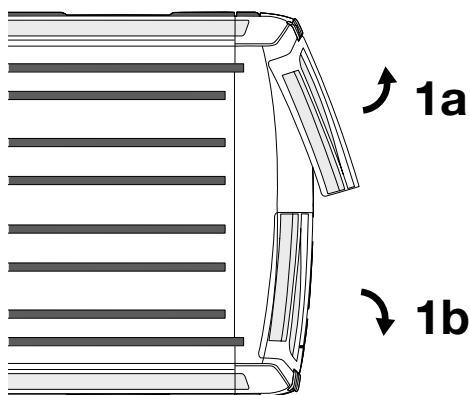

3. Press the button  to deactivate the RDO.

handiRDO™

REAR DOOR OPENER

Different versions of remote controls can occur + different lift version is also possible. Basis, function is the same, but some lifts are operated with 4-button operation.

DECLARATION OF
CONFORMITY



handiRDO™
REAR DOOR OPENER

autoproducts

AUTO PRODUCTS

Baggeskærvej 48
DK-7400 Herning
+45 96 28 96 20

sales@autoproducs.dk
www.autoproducts.eu

The undersigned,

Company name	: Autoproducts
Visiting address	: Baggeskærvej 48
Postcode	: 7400
City	: Herning
Country	: Denmark
Telephone	: +45 96 28 96 20
E-mail	: sales@autoproducs.dk
Home page	: www.autoproducts.eu

being the manufacturer, declares under his sole responsibility that the product:

Product name	: HandiRDO™
Product Type	: Rear Door Opener
Brand	: Handicare

to which this declaration relates are in conformity with the provisions of directives and standards:

2006/42/EC

74/61/EC

70/387/EC

Date : **Herning, 1st of June 2022**

Signature

Name	: Kenneth Jensen
Position	: Administrerende direktør / Managing Director

Warranty

handiRDO™
REAR DOOR OPENER

Warranty for products sold under the responsibility of Handicare:

Autoproducts warrants to the original purchaser of this product that we will repair or replace any faulty parts, at our discretion.

Warranty period:

Any parts that fail by reason of defective material or workmanship will be offered a replacement of all parts for a period of one year. Labor costs for specified parts replaced under warranty are not covered by this warranty. If applicable the product specific extended warranty obligations can be found online.

This warranty does not cover:

Damage caused by accident, misuse, abuse, lack of proper maintenance or failure to follow operating instructions. Required maintenance or repairs must be performed at that time, or as needed. Autoproducts Products obligation under this warranty is exclusively limited to the repair or exchange of parts that fail within the applicable warranty period, and Autoproducts assumes no responsibility for any other expenses or damages, including incidental or consequential damages.

This Warranty is void if:

The product has been modified or altered in any respect from its original design without written authorization by Autoproducts as this product has been designed and manufactured to a specific purpose. Modification of this product in any respect is DANGEROUS.

Autoproducts disclaims liability for any personal injury or property damage that results from operation of a product that has been modified from the original Autoproducts design. No person or company is authorized to change the design of this product without written authorization by Autoproducts .

Warranty handling procedure:

Returning of parts / goods with a warranty claim can only take place with a pre-written agreement in the form of a "return number" issued by Autoproducts , as well as a completely filled Warranty Claim form. The claims form can be found online.

Claim validation process – spare parts and products (hereafter named goods):

Autoproducts will when needed as soon as possible send a replacement for the claimed goods. Any replacement goods will be invoiced to the customer.

Claimed goods which are applicable to be covered by the warranty must be returned to Autoproducts without delay, with a copy of the original invoice, and the warranty claim form describing the default in the claimed warranty goods. Autoproducts will upon receipt inspect the returned claimed goods. The customer pays for the freight cost in connection with returning goods to Autoproducts Products at warranty issues.

In case the goods is covered by the warranty, there will be made a credit note for the replacement goods which has been send earlier. If the claim is not accepted under the warranty, the invoice must be fully paid.

Unless anything else has been agreed the risk for the replacement goods is passed on to the purchaser by delivery at sellers address (Incoterms 2010 EX Works). Furthermore we refer to our general sales- and delivery terms.



handicare

Baggeskærvej 48
DK-7400 Herning
T +45 97 12 96 22
autoproducs@handicare.dk
handicare.dk